

WASHTENAW COMMUNITY COLLEGE CAMPUS WIDE MAIN LOOP ROAD REPAIR PROJECT #75295 PART 1 WCC MAIN CAMPUS

CONSTRUCTION NOTES:

- IT IS ESSENTIAL THAT THE CONTRACTOR FAMILIARIZE HIMSELF WITH THE SITE PRIOR TO SUBMITTING PROPOSAL.
- ALL CONSTRUCTION SHALL BE PERFORMED PER THE CURRENT WASHTENAW COUNTY ROAD COMMISSION STANDARD SPECIFICATIONS. IF THERE ARE WORK ITEMS NOT COVERED BY THE ABOVE SPECIFICATIONS, THEN THE CURRENT M.D.O.T. SPECIFICATIONS SHALL APPLY AS DIRECTED IN THE PLANS AND SPECIFICATIONS.
- THE AREA WITHIN THE CONSTRUCTION LIMITS SHALL BE STRIPPED OF ORGANIC SOILS PRIOR TO COMMENCING GENERAL EXCAVATION. THIS MATERIAL SHALL BE STOCKPILED ON THE PROPERTY AT A LOCATION DIRECTED BY THE ENGINEER OR THE OWNER.
- THE CONTRACTOR WILL BE REQUIRED TO PROOF ROLL (WITH A HEAVY RUBBER-TIRED VEHICLE) ALL FILL AREAS PRIOR TO PLACING ADDITIONAL FILL AND ALL CUT AREAS UPON COMPLETION OF THE CUT AND PRIOR TO PLACING BASE MATERIAL. IF THE PROOF ROLLING INDICATES UNSTABLE AREAS, THE UNSTABLE MATERIAL MUST BE REMOVED AND REPLACED WITH MATERIAL MATCHING THE ADJACENT SOILS TO THE ELEVATION OF THE SUBGRADE.
- ALL FILL MATERIAL MUST BE PLACED IN LIFTS NOT EXCEEDING 9 INCHES AND COMPACTED TO 95% OF THE MAXIMUM UNIT WEIGHT.
- THE FINISHED SUBGRADE MUST BE GRADED WITHIN A TOLERANCE OF $\pm 1/4$ - 0.1 FEET OF DESIGN GRADE COMPACTED TO NOT LESS THAN 95% OF THE MAXIMUM UNIT WEIGHT TO A DEPTH OF 9 INCHES AND APPROVED BY THE OWNER'S REPRESENTATIVE/ENGINEER PRIOR TO PLACEMENT OF THE AGGREGATE BASE. FINE GRADING, PRIOR TO THE PLACEMENT OF THE BASE MATERIAL, SHALL BE INCLUDED IN THE COST OF PREPARING THE SUBGRADE.
- ALL DISTURBED AREAS, DITCH BOTTOMS AND SLOPES UNLESS OTHERWISE NOTED, SHALL BE SEEDED AND MULCHED PER 2020 M.D.O.T. STANDARD SPECIFICATIONS FOR CONSTRUCTION.
- THE CONTRACTOR MUST CONTACT MISS DIG PRIOR TO BEGINNING CONSTRUCTION.
- ALL CONSTRUCTION ACTIVITIES SHALL BE SIGNED PER THE 2025 MICHIGAN MANUAL OF UNIFORM TRAFFIC CONTROL DEVICES. THE CONTRACTOR SHALL MAINTAIN ACCESS FOR EMERGENCY VEHICLES AT ALL TIMES.
- THE CONTRACTOR SHALL BE RESPONSIBLE FOR INSTALLATION, MAINTENANCE AND REMOVAL OF ALL TEMPORARY EROSION CONTROL MEASURES PER THIS APPROVED PLAN.
- THE CONTRACTOR MUST OBTAIN AN EROSION CONTROL PERMIT PRIOR TO BEGINNING EARTH MOVING. THE CONTRACTOR WILL BE RESPONSIBLE FOR OBTAINING ALL NECESSARY PERMITS PRIOR TO BEGINNING CONSTRUCTION.
- ANY CONDITIONS (EXISTING) ON THE SITE THAT ARE NOT CONSISTENT WITH THE PLANS OR SOIL EROSION SEDIMENTATION PERMIT WILL RESULT IN A STOP-WORK ORDER AND REVOCATION OF THE SOIL EROSION SEDIMENTATION CONTROL PERMIT.
- ALL UTILITIES LYING WITHIN THE EXISTING OR PROPOSED INFLUENCE OF THE ROAD SHALL BE BACKFILLED WITH MDOT CUI MATERIAL, COMPACTED TO 95% MAXIMUM UNIT WEIGHT, PER THE WASHTENAW COUNTY ROAD COMMISSION.
- ALL DISTURBED AREAS THAT ARE OUTSIDE THE PAVED SURFACES AND GRAVEL SHOULDERS SHALL BE COVERED WITH A MINIMUM OF 4 INCHES OF TOPSOIL, SEEDED & MULCHED.
- IT SHALL BE THE CONTRACTOR'S RESPONSIBILITY TO VERIFY AND/OR OBTAIN ANY INFORMATION NECESSARY REGARDING THE PRESENCE OF UNDER-GROUND UTILITIES THAT MAY AFFECT THE WORK.
- CONTRACTOR SHALL BE RESPONSIBLE FOR DAMAGE TO AND THE REPAIR OF ANY EXISTING UTILITY LINE IN THE CONSTRUCTION ZONE.
- THE LOCATION OF EXISTING UTILITIES AS SHOWN ON THE PLANS ARE ONLY APPROXIMATE. NO FIELD VERIFICATION OF EXISTING UTILITY LINES HAS BEEN DONE.
- THE CONTRACTOR SHALL SUBMIT A DETAILED CONSTRUCTION SCHEDULE FOR THE PROJECT PRIOR TO SANITARY CONSTRUCTION.
- THE CONTRACTOR SHALL HAVE ALL UTILITY CROSSINGS DUG UP AND EXPOSED PRIOR TO SANITARY DIRECTION DRILLING. ELEVATIONS SHALL BE REPORTED TO WASHTENAW COMMUNITY COLLEGE AND THE ENGINEER.
- ALL DISTURBED LAWN AREAS SHALL BE RESTORED BACK TO EXISTING CONDITIONS, INCLUDING DUG UP LOCATIONS, TIRE MARKS OR STORED DIRT SPACES.
- THE CONTRACTOR SHALL BE RESPONSIBLE FOR VIDEO OF EXISTING CONDITIONS PRIOR TO START OF WORK.
- THE CONTRACTOR IS TO SPECIFY ALL PARKING AND LANE CLOSURES TO WASHTENAW COMMUNITY COLLEGE PRIOR TO START OF CONSTRUCTION.
- THE CONTRACTOR SHALL SUBMIT ALL MATERIAL AND SHOP DRAWINGS TO THE ENGINEER FOR APPROVAL PRIOR TO STARTING WORK.

PARCEL I (North of Huron River Dr)

Commencing at the Southwest corner of Section 31, T2S, R7E, Superior Township, Washtenaw County, Michigan; thence N87°38'08"W 50.12 feet along the South line of said Section and the centerline of Clark Road to the Point of Beginning; thence continuing S87°36'34"W 272.46 feet along said South line and said centerline to the South 1/4 corner of said Section 36; thence S87°37'02"W 766.01 feet continuing along said South line and said centerline; thence N01°36'52"E 1319.82 feet; thence S88°08'50"W 11.65 feet along the South line of the North 1/2 of the Southwest 1/4 of said Section to a point on the Eastern line of "ESKERMOOR NO. 2" as recorded in Liber 16 of Plats, Pages 2 and 3, Washtenaw County Records; thence N01°40'08"E 43.94 feet along said East line to the Northeast corner of said "ESKERMOOR NO. 2"; thence S88°32'02"W 880.06 feet along the North line of said "ESKERMOOR NO. 2"; thence S00°24'02"W 46.17 feet along the West line of said "ESKERMOOR NO. 2"; thence S88°16'02"W 424.02 feet; thence N02°22'58"E 6.20 feet; thence S87°37'02"W 212.50 feet; thence S02°22'58"E 274.00 feet; thence S32°22'58"E 86.39 feet; thence Southwesterly 38.54 feet along the arc of a 73.61 foot radius circular curve to the left, through a central angle of 30°00'00", having a chord that bears S42°37'02"W 38.10 feet; thence Southwesterly 77.08 feet along the arc of a 73.61 foot radius circular curve to the right, through a central angle of 60°00'00", having a chord that bears S67°37'02"W 73.61 feet; thence S87°37'02"W 20.00 feet; thence Northwesterly 77.08 feet along the arc of a 73.61 foot radius circular curve to the right, through a central angle of 60°00'00", having a chord that bears N62°22'58"W 73.61 feet; thence Northwesterly 77.08 feet along the arc of a 73.61 foot radius circular curve to the left, through a central angle of 60°00'00", having a chord that bears N62°22'58"W 73.61 feet; thence S87°37'02"W 19.15 feet to a point on the Easterly right-of-way line of Hogback Road; thence Northwesterly along said right-of-way line in the following four (4) courses: (1) Northeasterly 472.16 feet along the arc of a 894.93 foot radius circular curve to the right, through a central angle of 30°13'44", having a chord that bears N29°24'33"E 466.70 feet, (2) N44°31'25"E 556.12 feet, (3) Northeasterly 792.04 feet along the arc of a 1989.86 foot radius circular curve to the left, through a central angle of 23°02'15", having a chord that bears N33°00'17"E 786.72 feet and (4) N21°28'10"E 245.58 feet to a point on the East and West 1/4 line of said Section; thence N88°40'22"E 903.86 feet along said East and West 1/4 line; thence N28°58'54"W 87.97 feet (recorded as 87.80 feet); thence N23°33'24"W 302.92 feet; thence N24°48'54"W 257.22 feet; thence N88°46'36"E 83.52 feet along the Southerly right-of-way of East Huron River Drive (Variable Width); thence N01°13'24"W 50.00 feet to the centerline of said East Huron River Drive; thence N88°46'36"E 475.81 feet along the said centerline; thence S01°25'14"W 644.05 feet (recorded as 644.01 feet) along the North and South 1/4 line as monumented by Atwell-Hicks's 1976 survey, job no. 32564, to the Center of said Section; thence N88°29'54"E 131.17 feet; thence N87°52'39"E 316.71 feet; thence N01°57'43"E 486.42 feet to a point on the Southwesterly right-of-way line of said East Huron River Drive; thence Southwesterly and Southerly along said right-of-way line in the following seven (7) courses: (1) Southeasterly 62.25 feet along the arc of a 347.90 foot radius circular curve to the right, through a central angle of 10°15'13", having a chord that bears S59°28'14"E 62.18 feet, (2) S54°17'38"E 476.55 feet, (3) S63°35'23"E 2326.46 feet, (4) Southerly 987.38 feet along the arc of a 800.00 foot radius circular curve to the right, through a central angle of 94°17'08", having a chord that bears S05°43'20"E 879.88 feet, (5) S41°25'14"W 192.76 feet, (6) Southwesterly 486.42 feet along the arc of a 700.00 foot radius circular curve to the left, through a central angle of 39°45'51", having a chord that bears S21°30'49"W 476.89 feet, and (7) S01°38'23"W 200.38 feet to the Point of Beginning. Being a part of Section 36, T2S, R6E, Ann Arbor Township and a part of the Southwest 1/4 of Section 31, T2S, R7E, Superior Township, Washtenaw County, Michigan and containing 47 acres of land, more or less. Being subject to easements and restrictions of record, if any.

PARCEL II (South of Huron River Dr)

Commencing at the Southeast corner of Section 36, T2S, R6E, Ann Arbor Township, Washtenaw County, Michigan; thence S87°36'34"W 50.12 feet along the South line of said Section and the centerline of Clark Road to the POINT OF BEGINNING; thence continuing S87°36'34"W 272.46 feet along said South line and said centerline to the South 1/4 corner of said Section 36; thence S87°37'02"W 766.01 feet continuing along said South line and said centerline; thence N01°36'52"E 1319.82 feet; thence S88°08'50"W 11.65 feet along the South line of the North 1/2 of the Southwest 1/4 of said Section to a point on the Eastern line of "ESKERMOOR NO. 2" as recorded in Liber 16 of Plats, Pages 2 and 3, Washtenaw County Records; thence N01°40'08"E 43.94 feet along said East line to the Northeast corner of said "ESKERMOOR NO. 2"; thence S88°32'02"W 880.06 feet along the North line of said "ESKERMOOR NO. 2"; thence S00°24'02"W 46.17 feet along the West line of said "ESKERMOOR NO. 2"; thence S88°16'02"W 424.02 feet; thence N02°22'58"E 6.20 feet; thence S87°37'02"W 212.50 feet; thence S02°22'58"E 274.00 feet; thence S32°22'58"E 86.39 feet; thence Southwesterly 38.54 feet along the arc of a 73.61 foot radius circular curve to the left, through a central angle of 30°00'00", having a chord that bears S42°37'02"W 38.10 feet; thence Southwesterly 77.08 feet along the arc of a 73.61 foot radius circular curve to the right, through a central angle of 60°00'00", having a chord that bears S67°37'02"W 73.61 feet; thence S87°37'02"W 20.00 feet; thence Northwesterly 77.08 feet along the arc of a 73.61 foot radius circular curve to the right, through a central angle of 60°00'00", having a chord that bears N62°22'58"W 73.61 feet; thence Northwesterly 77.08 feet along the arc of a 73.61 foot radius circular curve to the left, through a central angle of 60°00'00", having a chord that bears N62°22'58"W 73.61 feet; thence S87°37'02"W 19.15 feet to a point on the Easterly right-of-way line of Hogback Road; thence Northwesterly along said right-of-way line in the following four (4) courses: (1) Northeasterly 472.16 feet along the arc of a 894.93 foot radius circular curve to the right, through a central angle of 30°13'44", having a chord that bears N29°24'33"E 466.70 feet, (2) N44°31'25"E 556.12 feet, (3) Northeasterly 792.04 feet along the arc of a 1989.86 foot radius circular curve to the left, through a central angle of 23°02'15", having a chord that bears N33°00'17"E 786.72 feet and (4) N21°28'10"E 245.58 feet to a point on the East and West 1/4 line of said Section; thence N88°40'22"E 903.86 feet along said East and West 1/4 line; thence N28°58'54"W 87.97 feet (recorded as 87.80 feet); thence N23°33'24"W 302.92 feet; thence N24°48'54"W 257.22 feet; thence N88°46'36"E 83.52 feet along the Southerly right-of-way of East Huron River Drive (Variable Width); thence N01°13'24"W 50.00 feet to the centerline of said East Huron River Drive; thence N88°46'36"E 475.81 feet along the said centerline; thence S01°25'14"W 644.05 feet (recorded as 644.01 feet) along the North and South 1/4 line as monumented by Atwell-Hicks's 1976 survey, job no. 32564, to the Center of said Section; thence N88°29'54"E 131.17 feet; thence N87°52'39"E 316.71 feet; thence N01°57'43"E 486.42 feet to a point on the Southwesterly right-of-way line of said East Huron River Drive; thence Southwesterly and Southerly along said right-of-way line in the following seven (7) courses: (1) Southeasterly 62.25 feet along the arc of a 347.90 foot radius circular curve to the right, through a central angle of 10°15'13", having a chord that bears S59°28'14"E 62.18 feet, (2) S54°17'38"E 476.55 feet, (3) S63°35'23"E 2326.46 feet, (4) Southerly 987.38 feet along the arc of a 800.00 foot radius circular curve to the right, through a central angle of 94°17'08", having a chord that bears S05°43'20"E 879.88 feet, (5) S41°25'14"W 192.76 feet, (6) Southwesterly 486.42 feet along the arc of a 700.00 foot radius circular curve to the left, through a central angle of 39°45'51", having a chord that bears S21°30'49"W 476.89 feet, and (7) S01°38'23"W 200.38 feet to the Point of Beginning. Being a part of Section 36, T2S, R6E, Ann Arbor Township and a part of the Southwest 1/4 of Section 31, T2S, R7E, Superior Township, Washtenaw County, Michigan and containing 237.23 acres of land, more or less. Being subject to the rights of the public over that portion of East Huron River Drive and Clark Road as occupied. Also being subject to easements and restrictions of record, if any.

A PART OF THE SE 1/4 SECTION 36 T2S, R6E, ANN ARBOR TOWNSHIP AND
A PART OF THE SW 1/4 SECTION 31 T2S, R7E, SUPERIOR TOWNSHIP
WASHTENAW COUNTY, MICHIGAN

FOR:
WASHTENAW COMMUNITY COLLEGE

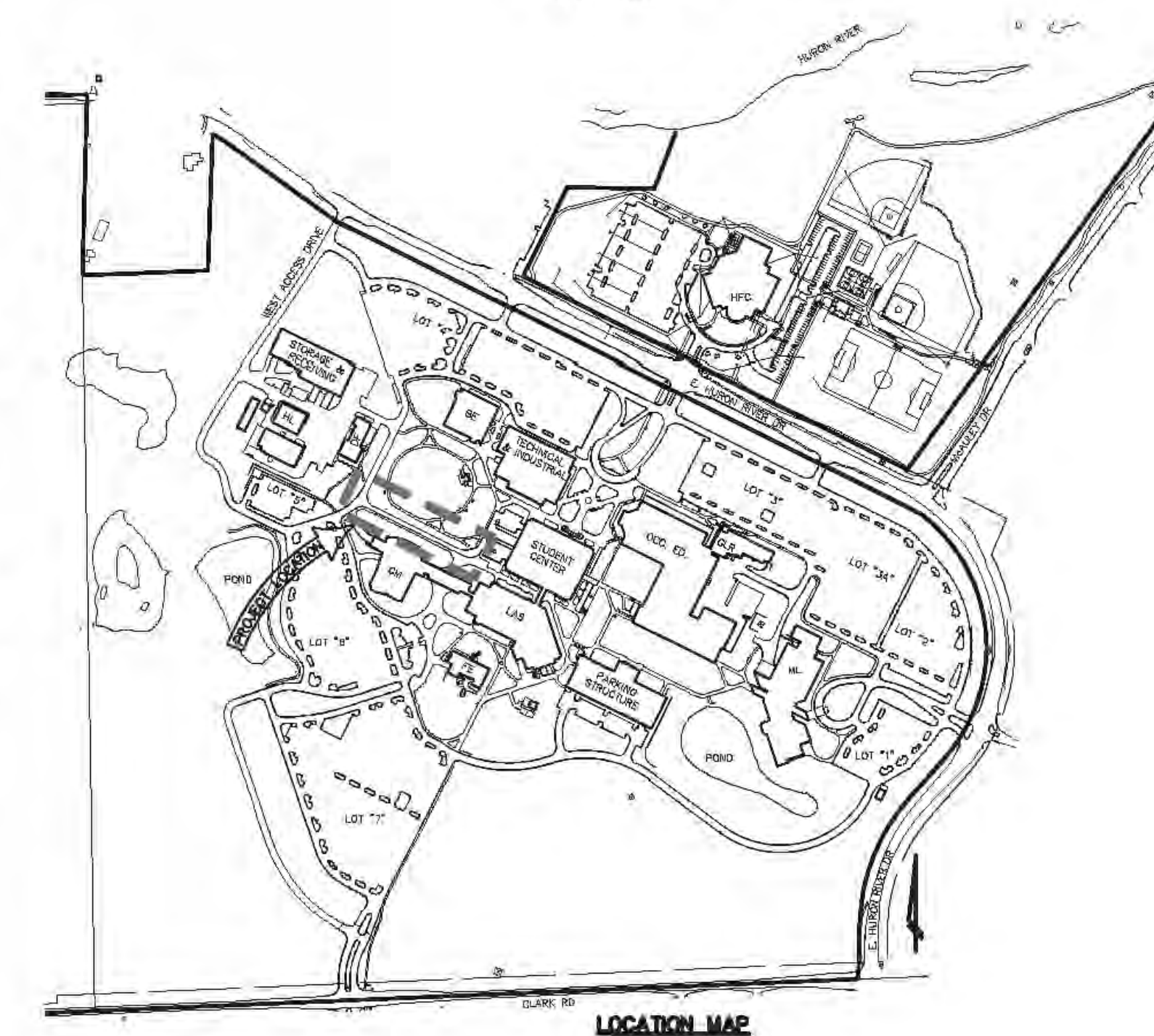
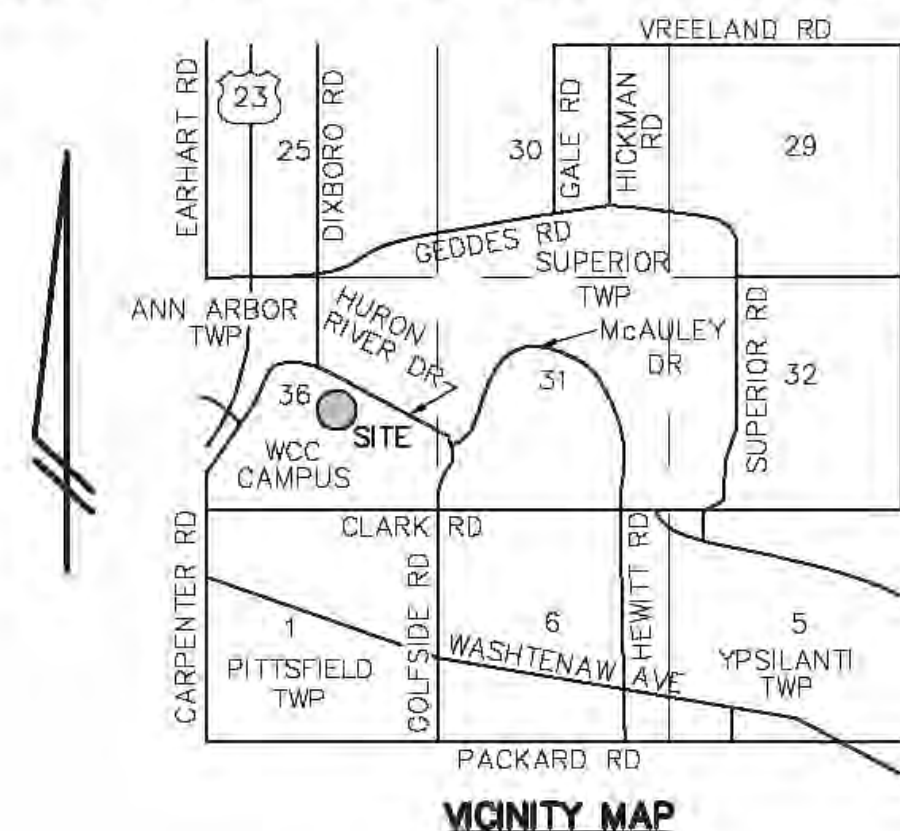

PROJECT DESCRIPTION

THIS PROJECT IS LOCATED ON THE SOUTH SIDE OF E HURON RIVER DR. BETWEEN N DIXBORO RD AND CLARK ROAD IN ANN ARBOR TOWNSHIP AND SUPERIOR TOWNSHIP, WASHTENAW COUNTY, MICHIGAN.

THE EXISTING SITE IS WELL DEVELOPED AS A COLLEGE CAMPUS. THERE ARE MULTIPLE BUILDINGS, ROADWAYS AND SIDEWALKS. THERE IS AN EXISTING STORM WATER SYSTEM WITH MULTIPLE DETENTION BASINS AND SEWER PIPE. THERE IS A HEALTH AND FITNESS CENTER BELONGING TO THE COLLEGE ON THE NORTH SIDE OF E HURON RIVER DR.. TO THE EAST THERE IS THE TRINITY HEALTH ANN ARBOR HOSPITAL.

PART 1 - COMMUNITY PARK ROAD WIDENING

THIS PART OF THE PROJECT WILL BE TO WIDEN THE CURRENT ACCESS DRIVE THAT IS LOCATED BEHIND THE GUNDER MYRAN BUILDING AND THE COMMUNITY PARK. THIS DRIVE LANE SERVES THE LOADING DOCK AT THE STUDENT CENTER BUILDING AND HAS A NUMBER OF PARKING AND ADA PARKING SPACES. THE ROADWAY IS CURRENTLY TOO NARROW TO SERVE AS TWO WAY TRAFFIC OFTEN TIMES REQUIRING DRIVERS TO DRIVE ON THE SIDEWALK TO PASS. THE PROJECT WILL WIDEN THE ROAD TO 22 FOOT WIDE AND PROVIDE IMPROVED ADA ACCESS AND DRAINAGE CONTROLS.

CONTRACTOR BID NOTES:

- THE CONTRACTOR SHALL PROVIDE A WORK PLAN AND SCHEDULE ON OBTAINING ALL NECESSARY PERMITS, MATERIALS AND PROCUREMENT OF LONG LEAD ITEMS FOR WORK TO BEGIN AND COMPLETE. THIS SHALL BE SUBMITTED TO OWNER 2 WEEKS PRIOR TO AWARD OF CONTRACT.
- THE CONTRACTOR SHALL NOTE THAT THIS PROJECT IS WITHIN THE BOUNDARIES OF TWO TOWNSHIPS: ANN ARBOR TOWNSHIP AND SUPERIOR TOWNSHIP. THE CONTRACTOR SHALL COORDINATE PERMITTING APPROVALS FOR WORK PERTAINING TO EACH TOWNSHIP. NOTE THAT PART 1 IS ONLY WITHIN ANN ARBOR TOWNSHIP.
- WCC REQUEST THAT THIS BID INCLUDES A MANDATORY ALLOWANCE OF \$20,000.00 THIS AMOUNT WILL BE USED FOR POTENTIAL CHANGES OR ADDED WORK SCOPE AND WILL BE DEDUCTED FOR USE BY WCC. REMAINING AMOUNTS WILL BE RETURNED AT JOB CLOSEOUT.
- CONTRACTOR TO INCLUDE ALL REQUIRED EROSION CONTROL MEASURES AS A LUMP SUM FEE FOR PROJECT.
- CONTRACTOR SHALL COMPLETE ALL REQUIRED FINAL CLEAN UP AS REQUIRED AND DIRECTED BY OWNER DR OWNERS ENGINEER AS A LUMP SUM FEE.
- ALL DISTURBED AREAS SHALL BE RESTORED AS TURF ESTABLISHMENT AS A LUMP SUM FEE.
- CONTRACTOR TO PROVIDE ALL TRAFFIC CONTROL DEVICES AS PART OF PROJECT UNDER TRAFFIC CONTROL AS A LUMP SUM FEE.

PERMITS ARE CONTRACTORS RESPONSIBILITY TO SECURE FOR PART 1.

ANN ARBOR TOWNSHIP SOIL EROSION

PERMIT #:
ISSUE DATE:
ENGINEER WILL INSPECT SESS MEASURES ON SITE AND COORDINATE REPAIRS AND MAINTENANCE AS NEEDED.

SHEET TITLE

| SHEET TITLE | SHEET NO. |
|--|-----------|
| COVER SHEET | 1 |
| OVERALL EXISTING CONDITIONS | 2 |
| EXISTING CONDITIONS | 3 |
| REMOVAL PLAN | 4 |
| SITE PLAN | 5 |
| GRADING, UTILITY AND SOIL EROSION CONTROL PLAN | 6 |
| PHASING AND STAGING PLAN | 7 |

OWNER/APPLICANT
WASHTENAW COMMUNITY COLLEGE
4800 E. HURON RIVER DRIVE
PO BOX D-1
ANN ARBOR, MICHIGAN 48105



WASHTENAW ENGINEERING
CIVIL ENGINEERS * PLANNERS
SURVEYORS * LANDSCAPE ARCHITECTS
P.O. BOX 1128
3250 WEST LIBERTY RD ANN ARBOR, MICHIGAN 48106
TEL 734-761-8800 FAX 734-761-9530
E-MAIL: wce@wengco.com



PREPARED BY: *Joseph K. Maynard*
JOSEPH K. MAYNARD P.E., MICH No. 52559

PROJECT # 33285

BIDDING AND PERMIT REVIEW SET 5-28-2026

CAMPUS WIDE MAIN LOOP ROAD REPAIR PROJECT #75295 PART 1

THE UNDERGROUND UTILITIES SHOWN HAVE BEEN LOCATED FROM FIELD SURVEY INFORMATION AND EXISTING RECORDS. THE SURVEYOR MAKES NO WARRANTY, EXPRESS OR IMPLIED, THAT THE INFORMATION IS ACCURATE OR COMPLETE. THE SURVEYOR MAKES NO WARRANTY, EXPRESS OR IMPLIED, THAT THE INFORMATION IS ACCURATE OR COMPLETE. THE SURVEYOR MAKES NO WARRANTY, EXPRESS OR IMPLIED, THAT THE INFORMATION IS ACCURATE OR COMPLETE. THE SURVEYOR MAKES NO WARRANTY, EXPRESS OR IMPLIED, THAT THE INFORMATION IS ACCURATE OR COMPLETE.

CONSENT OF WASHTENAW ENGINEERING COMPANY, INC. NO REPRODUCTION SHALL BE MADE WITHOUT PRIOR WRITTEN CONSENT OF WASHTENAW ENGINEERING COMPANY, INC.

THE OWNER SHALL NOT USE OR AUTHORIZE ANY OTHER PERSON TO USE THE DRAWINGS, SPECIFICATIONS, ELECTRONIC DATA AND ANY OTHER INSTRUMENTS OF SERVICE FOR ANY PROJECT OR FOR ANY PURPOSE OTHER THAN THAT FOR WHICH THE DRAWINGS, SPECIFICATIONS, ELECTRONIC DATA AND ANY OTHER INSTRUMENTS OF SERVICE WERE PREPARED. THE OWNER SHALL INDEMNIFY AND HOLD HARMLESS THE ENGINEER AND ARCHITECT AND EMPLOYEES OF ANY OF THEM FROM AND AGAINST ALL CLAIMS, DAMAGES, LOSSES AND EXPENSES, INCLUDING REASONABLE ATTORNEY'S FEES, THAT MAY BE ASSERTED AGAINST OR INCURRED BY THE ENGINEER AND ARCHITECT OR ANY OF THEM FROM ANY CAUSE, INCLUDING NEGLIGENCE, IN CONNECTION WITH THE PERFORMANCE OF THEIR PROFESSIONAL SERVICES.

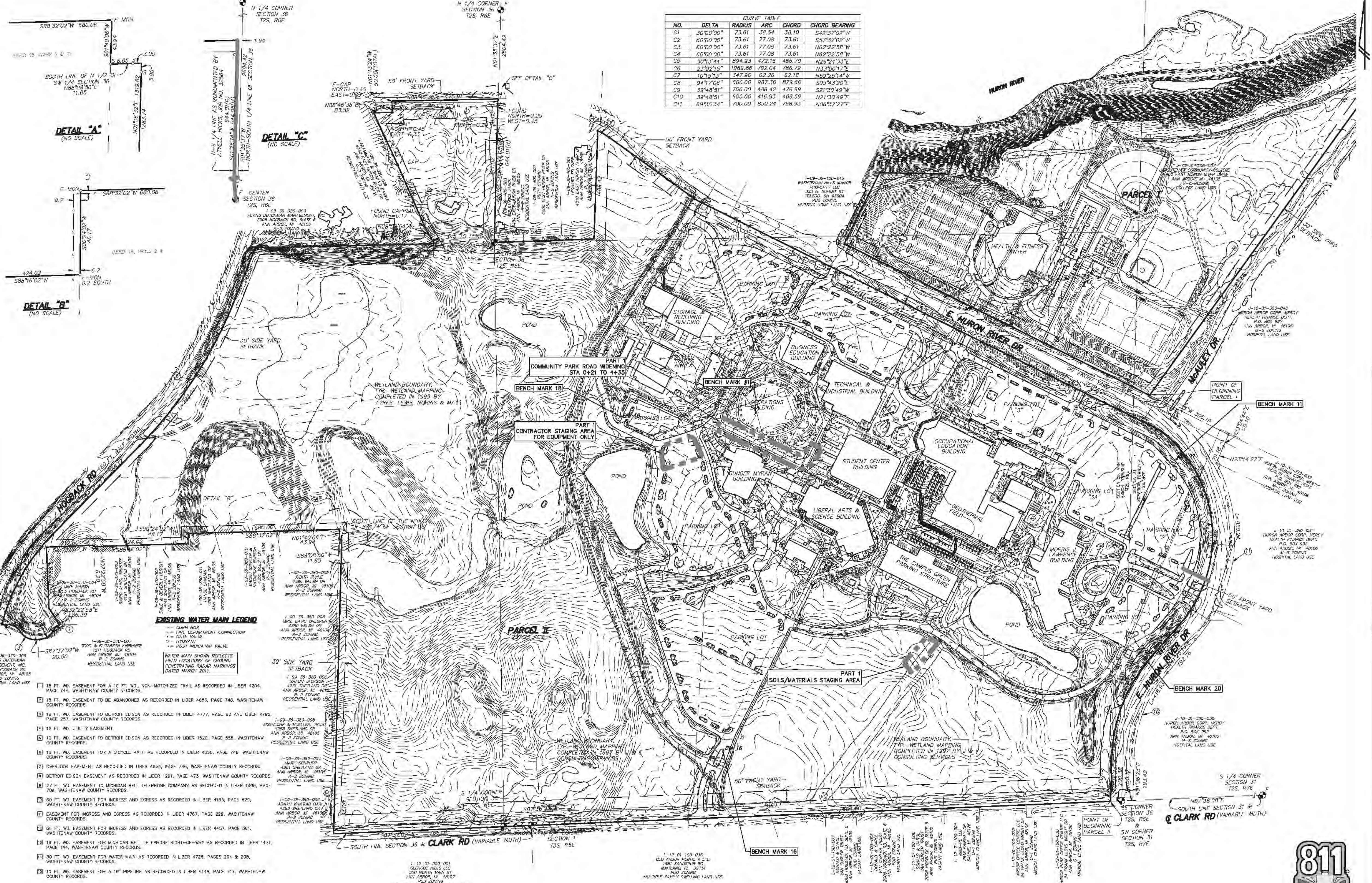

NOTE: CONTOURS WERE GENERATED FROM PHOTOGRAMMETRIC MAPPING OF SITE BY AEROCOR PHOTOGRAMMETRIC SERVICES INC., JOB NO. 9889.

| BENCHMARK NO. | NORTHING | EASTING | ELEVATION | DESCRIPTION |
|---------------|-----------|-------------|-----------|-------------------|
| BM11 | 277981.75 | 13314586.53 | 820.68 | CONCRETE MONUMENT |
| BM16 | 277772.12 | 13312548.68 | 816.93 | CONCRETE MONUMENT |
| BM18 | 279273.23 | 13312089.03 | 787.00 | CONCRETE MONUMENT |
| BM20 | 278199.37 | 13314433.30 | 820.33 | CONCRETE MONUMENT |

COORDINATE VALUES ARE IN THE MICHIGAN COORDINATE SYSTEM OF 1983, SOUTH ZONE. DATUM=NAVD 88

WASHTENAW COUNTY SOIL SURVEY CLASSIFICATION
 - ST. CLAIR CLAY LOAM, 2 TO 6 PERCENT SLOPES
 - SOILS ARE BASED ON USDA SOIL SURVEY OF WASHTENAW COUNTY.

EXISTING SIGN LEGEND
 1 - SIDE
 2 - POLICE PARKING ONLY
 3 - NO PARKING FIRE LANE
 4 - CAMPUS DIRECTIONAL
 5 - BARRIEN FREE PARKING



PREPARED BY: *Joseph R. Maynard*
 JOSEPH R. MAYNARD P.E., MICH No. 52559

| LEGEND | SYMBOL | DESCRIPTION |
|--------------------|--------|--------------------|
| SPOT ELEV. | • | SPOT ELEV. |
| POST | ○ | POST |
| MANHOLE | ⊗ | MANHOLE |
| GATE VALVE | ⊕ | GATE VALVE |
| HYDRANT | ⊙ | HYDRANT |
| TOP OF CURB | — | TOP OF CURB |
| TOP OF WALL | — | TOP OF WALL |
| GRAVEL | ▨ | GRAVEL |
| FENCE | — | FENCE |
| CONCRETE | ▣ | CONCRETE |
| ASPHALT | ▩ | ASPHALT |
| EXISTING STORM | — | EXISTING STORM |
| EXISTING SANITARY | — | EXISTING SANITARY |
| EXISTING WATER | — | EXISTING WATER |
| EXISTING GAS | — | EXISTING GAS |
| EXISTING ELECTRIC | — | EXISTING ELECTRIC |
| EXISTING TELEPHONE | — | EXISTING TELEPHONE |

| REVISIONS | DESCRIPTION |
|-----------|-------------------------|
| 1 | ISSUED FOR PERMIT |
| 2 | ISSUED FOR CONSTRUCTION |

CIVIL ENGINEERS
 PLANNERS • SURVEYORS
 LANDSCAPE ARCHITECTS
 3628 W. LIBERTY RD.
 SUITE 400
 ANN ARBOR, MI 48103
 TEL 734-767-8600

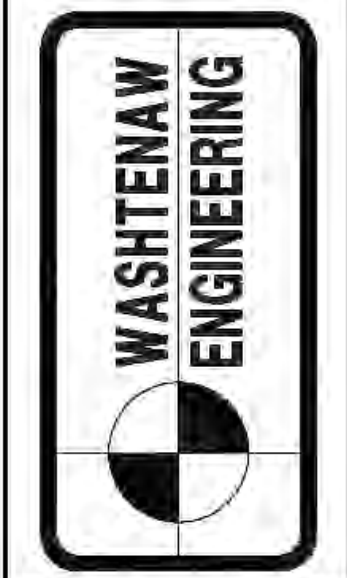

WASHTENAW
 COMMUNITY COLLEGE
 4800 E. HURON AVENUE, 2ND FLOOR
 ANN ARBOR, MI 48106
 TEL 734-973-3300
 www.wccnet.edu

CLIENT
 WASHTENAW COMMUNITY COLLEGE
 SHEET
 OVERALL
 EXISTING CONDITIONS

PROJECT
 CAMPUS WIDE
 MAIN LOOP REPAIR
 PROJECT #75295
 PART 1

| SECTION | TOWN | RANGE | EAST |
|---------|------|-------|------|
| 35 | 2 | 5 | 5 |

DATE 5-28-2026
 JOB NO. 53285
 DWG NO. 285-9-0A-exccn
 FIELD BOOK NONE
 FILE NO. 11015



Know what's below.
 Call before you dig.



THE UNDERGROUND UTILITIES SHOWN HAVE BEEN LOCATED FROM FIELD SURVEY INFORMATION AND EXISTING RECORDS. THE SURVEYOR MAKES NO WARRANTY AS TO THE ACCURACY OF THE INFORMATION PROVIDED. THE SURVEYOR DOES NOT WARRANT THAT THE INFORMATION IS COMPLETELY ACCURATE. THE SURVEYOR DOES NOT WARRANT THAT THE INFORMATION IS COMPLETELY ACCURATE. THE SURVEYOR DOES NOT WARRANT THAT THE INFORMATION IS COMPLETELY ACCURATE. THE SURVEYOR DOES NOT WARRANT THAT THE INFORMATION IS COMPLETELY ACCURATE.

CONSENT OF WASHTENAW ENGINEERING COMPANY, INC. TO REPRODUCE THIS DRAWING IN ANY MANNER WITHOUT WRITTEN PERMISSION OF WASHTENAW ENGINEERING COMPANY, INC.

THE OWNER SHALL NOT USE OR AUTHORIZE ANY OTHER PERSON TO USE THE DRAWINGS, SPECIFICATIONS, ELECTRONIC DATA AND OTHER INSTRUMENTS OF SERVICE ON OTHER PROJECTS. FOR ADDITION TO THIS PROJECT OR FOR COMPLETION OF THE PROJECT BY OTHER PERSONS, THE SURVEYOR SHALL BE ADVISED IN WRITING. THE SURVEYOR SHALL BE RESPONSIBLE FOR ANY AND ALL DAMAGES, INCLUDING REASONABLE ATTORNEY'S FEES, ARISING OUT OF ANY SUCH USE OR AUTHORIZATION. THE SURVEYOR SHALL BE RESPONSIBLE FOR ANY AND ALL DAMAGES, INCLUDING REASONABLE ATTORNEY'S FEES, ARISING OUT OF ANY SUCH USE OR AUTHORIZATION.

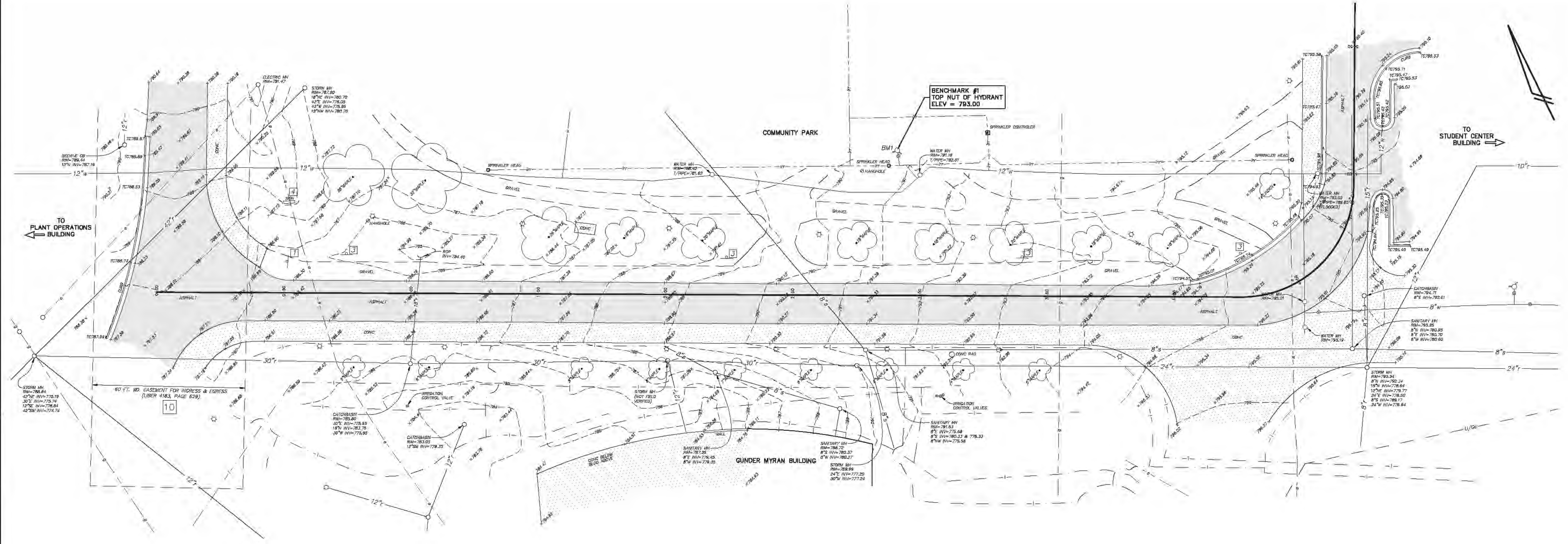

EXISTING WATER MAIN LEGEND

- cb = CURB BOX
- fdca = FIRE DEPARTMENT CONNECTION
- g = GATE VALVE
- h = HYDRANT
- pv = POST INDICATOR VALVE
- o = SPRINKLER HEAD
- sc = SPRINKLER CONTROL
- ir = IRRIGATION LINE

SPRINKLER SYSTEM SHOWN PER REDDICK RAEDER RANKIN LANDSCAPE ARCHITECT + PLANNERS PLANTING AND IRRIGATION PLAN WASHTENAW COMMUNITY COLLEGE COMMUNITY PARK DATED 8-12-1982

80 FT. WD. EASEMENT FOR INGRESS AND EGRESS AS RECORDED IN LIBER 4163, PAGE 629, WASHTENAW COUNTY RECORDS.

NOTE: THE GRAPHICAL REPRESENTATION OF THE DETROIT EDISON DRAWING AS-3308, DATED 1-20-75 IS DISTORTED AND ILLEGIBLE AS RECORDED IN LIBER 1520, PAGE 559, WASHTENAW COUNTY RECORDS.



WASHTENAW COUNTY SOIL SURVEY CLASSIFICATION

S1B - ST. CLAIR CLAY LOAM, 2 TO 6 PERCENT SLOPES

SOILS ARE BASED ON USDA SOIL SURVEY OF WASHTENAW COUNTY.

so = SOIL BORING

EXISTING SIGN LEGEND

- = STOP
- = POLICE PARKING ONLY
- = NO PARKING FIRE LANE
- = CAMPUS DIRECTIONAL
- = BARRIER FREE PARKING

LEGEND

- ☆ = LIGHT POLE
- = UTILITY POLE
- = GUY ANCHOR
- = HYDRANT
- = SPOT ELEV.
- = POST
- = GATE VALVE
- = SIGN
- TC = TOP OF CURB
- TW = TOP OF WALL
- = MANHOLE
- = CATCHBASIN
- = END SECTION
- = GRAVEL
- = FENCE
- = CONCRETE
- = ASPHALT
- = EXISTING STORM
- = EXISTING SANITARY
- = EXISTING WATER
- = EXISTING GAS
- = EXISTING ELECTRIC
- = EXISTING TELEPHONE

BENCHMARK BM1-TOP NUT ON HYDRANT, 116'± FROM THE NORTHEASTERLY CORNER OF GUNDER MYRAN BUILDING, ELEV=793.00 (NAVD. 88).

REVISIONS

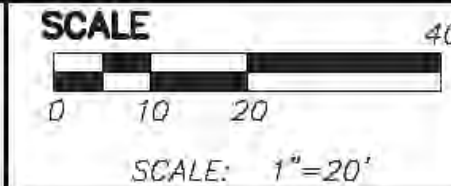

PREPARED BY: *Joseph K. Maynard*
 JOSEPH K. MAYNARD P.E., MICH No. 52559

811
 Know what's below. Call before you dig.

| | | | | |
|--|----------------|---------------------|-----------------|----------------|
| SECTION 36 | TOWN 2 | SOUTH | RANGE 6 | EAST |
| PROJECT CAMPUS WIDE MAIN LOOP REPAIR PROJECT #75295 PART 1 | | | | |
| DATE 5-28-2026 | JOB NO. 332285 | DWG NO. 282-9-BAKON | FIELD BOOK NONE | FILE NO. 11013 |
| SHEET 3 | | | | |

EXISTING CONDITIONS

WASHTENAW COMMUNITY COLLEGE
 4800 E. HURON RIVER DR
 ANN ARBOR, MI 48106
 TEL: 734-973-3300
 www.wccnet.edu

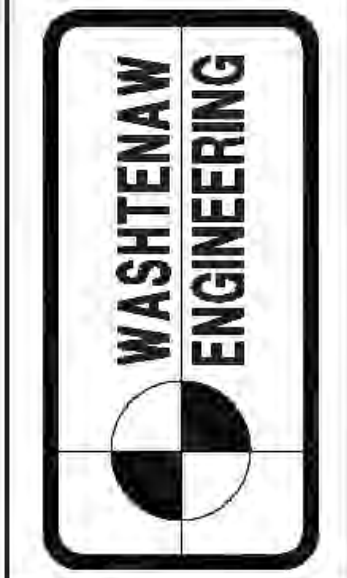

CIVIL ENGINEERS
 PLANNERS + SURVEYORS
 LANDSCAPE ARCHITECTS
 3502 W. LIBERTY RD
 SUITE 400
 ANN ARBOR, MI 48103
 TEL: 734-761-8800

THE UNDERGROUND UTILITIES SHOWN HAVE BEEN LOCATED FROM FIELD SURVEY INFORMATION AND EXISTING RECORDS. THE SURVEYOR MAKES NO WARRANTY AS TO THE ACCURACY OF THE INFORMATION PROVIDED. THE SURVEYOR DOES NOT WARRANT THAT THE INFORMATION PROVIDED IS COMPLETE OR THAT THE SURVEYOR DOES NOT MAKE ANY OTHER UTILITIES SHOWN ARE IN THE EXACT LOCATION INDICATED. THE SURVEYOR HAS NOT PHYSICALLY LOCATED THE UNDERGROUND UTILITIES.

COPYRIGHT © 2024 WASHTENAW ENGINEERING COMPANY, INC. NO REPRODUCTION SHALL BE MADE WITHOUT WRITTEN CONSENT OF WASHTENAW ENGINEERING COMPANY, INC.

THE OWNER SHALL NOT USE OR AUTHORIZE ANY OTHER PERSON TO USE THE DRAWINGS, SPECIFICATIONS, ELECTRONIC DATA AND OTHER INSTRUMENTS OF SERVICE ON OTHER PROJECTS. FOR ADDITION TO THIS PROJECT OR FOR COMPLETION OF THE PROJECT BY OTHER INSTRUMENTS OF SERVICE, THE SURVEYOR SHALL BE CONSULTED. THE SURVEYOR'S LIABILITY IS LIMITED TO THE SERVICE PROVIDED BY THE SURVEYOR AND DOES NOT INCLUDE THE LIABILITY OF ANY OTHER PARTY. THE SURVEYOR SHALL INDEMNIFY AND HOLD HARMLESS THE OWNER, ARCHITECT, ENGINEER AND EMPLOYEES OF ANY OF THEM FROM AND AGAINST ALL CLAIMS, DAMAGES, LOSSES AND EXPENSES, INCLUDING REASONABLE ATTORNEY'S FEES, ARISING OUT OF OR FROM THE PERFORMANCE OF THE SERVICES PROVIDED BY THE SURVEYOR.

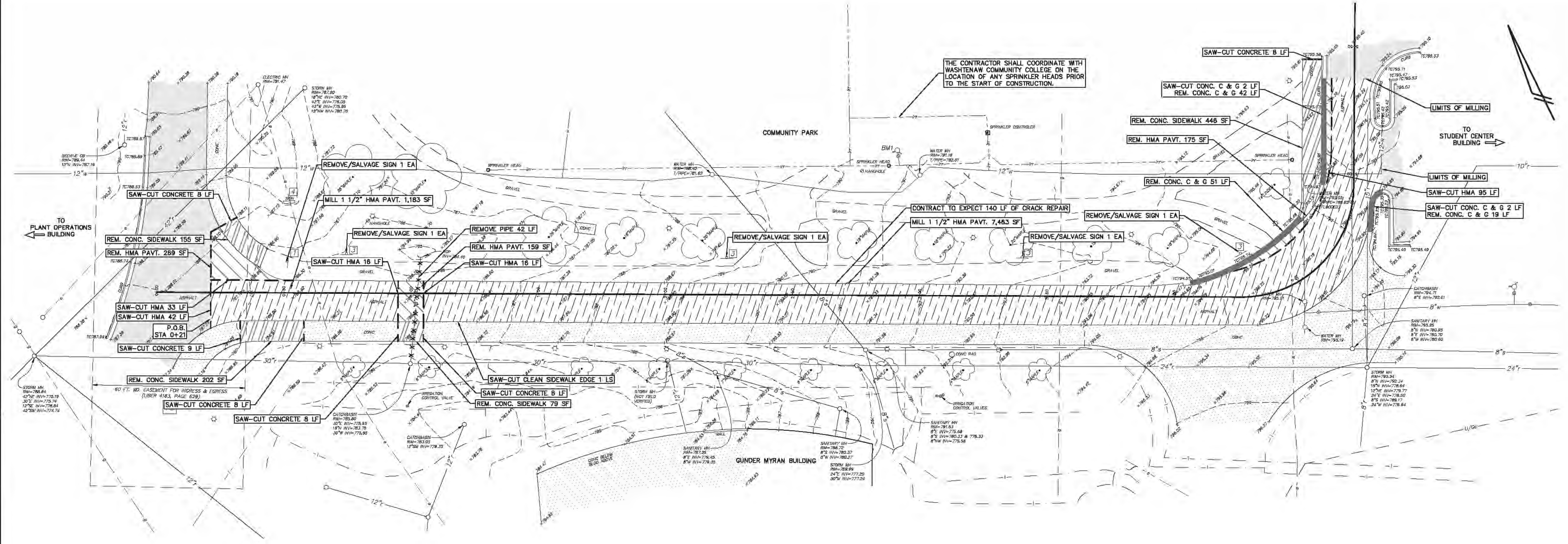

REMOVAL LEGEND

| | |
|------------|---------------------------------|
| | = REMOVE CONCRETE CURB & GUTTER |
| | = REMOVE ASPHALT SURFACE |
| | = MILL 1 1/2" ASPHALT SURFACE |
| | = REMOVE CONCRETE SURFACE |
| | = SAWCUT HMA SURFACE |
| XXXXXXXXXX | = REMOVE PIPE/LINE ITEM |

- NOTES:**
- ALL PAVEMENT MARKINGS REMOVED OR DAMAGED FROM THIS PROJECT ARE TO BE REPLACED WITH WATERBORNE.
 - CONTRACTOR IS RESPONSIBLE FOR LOCATING EXISTING UTILITIES (LIGHT POLE ELECTRIC CONDUITS). PREVIOUS PROJECTS ENCOUNTERED CONDUIT AT 12" TO 14" DEPTH FROM EXISTING SURFACE.
 - CONTRACTOR IS RESPONSIBLE FOR ACQUIRING ALL PERMITS REQUIRED FOR THIS PROJECT.
 - TRAVERSE OR LONGITUDINAL CRACK REPAIR: AFTER COLD MILLING OF 1.5" OF EXISTING HMA THE CONTRACTOR WILL REPAIR THE EXISTING CRACKS WITH THE HMA PAVEMENT REPAIR THERMAL BOND METHOD AS NOTED IN THE SPECIAL PROVISION OAK-AA.

EXISTING WATER MAIN LEGEND

| | |
|-----------------------------------|--------------------------|
| cb = CURB BOX | ○ = SPRINKLER HEAD |
| fdca = FIRE DEPARTMENT CONNECTION | ■ = SPRINKLER CONTROLLER |
| g = GATE VALVE | --- = IRRIGATION LINE |
| h = HYDRANT | |
| pv = POST INDICATOR VALVE | |

SPRINKLER SYSTEM SHOWN PER BIDDET READER RANKIN LANDSCAPE ARCHITECT + PLANNERS WASHTEANW COMMUNITY COLLEGE COMMUNITY PARK DATED 8-12-1982

80 FT. WD. EASEMENT FOR INGRESS AND EGRESS AS RECORDED IN LIBER 4163, PAGE 629, WASHTENAW COUNTY RECORDS.



WASHTENAW COUNTY SOIL SURVEY CLASSIFICATION

S1B - ST. CLAIR CLAY LOAM, 2 TO 6 PERCENT SLOPES

••••• SOILS BOUNDARY

SOILS ARE BASED ON USDA SOIL SURVEY OF WASHTENAW COUNTY.

○ = SOIL BORING

EXISTING SIGN LEGEND

| | |
|---|------------------------|
| □ | = STOP |
| □ | = POLICE PARKING ONLY |
| □ | = NO PARKING FIRE LANE |
| □ | = CAMPUS DIRECTIONAL |
| □ | = BARRIER FREE PARKING |

BENCHMARK BM1=TOP NUT ON HYDRANT, 116 1/2' FROM THE NORTHEASTERLY CORNER OF GUNDER MYRAN BUILDING, ELEV=793.00 (NAVD. 88).

REVISIONS

| | |
|--|--|
| | |
| | |

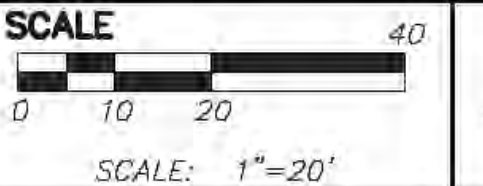

PREPARED BY: *Joseph K. Maynard*
 JOSEPH K. MAYNARD P.E., MICH No. 52559



Know what's below. Call before you dig.



CIVIL ENGINEERS
 PLANNERS + SURVEYORS
 LANDSCAPE ARCHITECTS
 3502 W. LIBERTY RD
 ANN ARBOR, MI 48103
 TEL: 734-761-8600

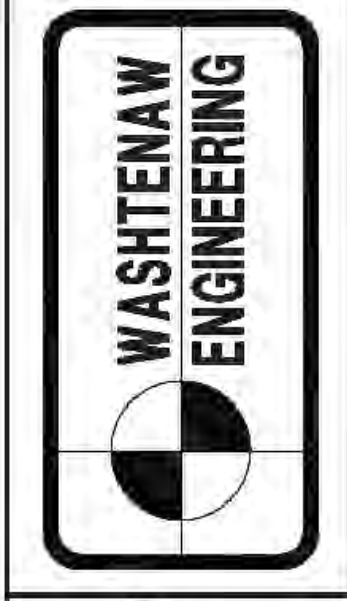

WASHTENAW COMMUNITY COLLEGE
 4800 E. HURON RIVER DR
 ANN ARBOR, MI 48106
 TEL: 734-973-3300
 www.wccnet.edu

REMOVAL PLAN

CAMPUS WIDE MAIN LOOP REPAIR PROJECT #75295 PART 1

| | | | | |
|----------------|-----------------------------|----------------|-------------------|-----------------|
| SECTION 36 | TOWN 2 | SOUTH | RANGE 6 | EAST |
| DATE 5-28-2026 | WASHTENAW COUNTY - MICHIGAN | JOB NO. 332285 | DWG NO. 282-9-001 | FIELD BOOK NONE |
| | | | | FILE NO. 11013 |

THE UNDERGROUND UTILITIES SHOWN HAVE BEEN LOCATED FROM FIELD SURVEY INFORMATION AND EXISTING RECORDS. THE SURVEYOR MAKES NO WARRANTY AS TO THE ACCURACY OF THE INFORMATION SHOWN. THE SURVEYOR DOES NOT WARRANT THAT THE INFORMATION SHOWN IS IN THE EXACT LOCATION INDICATED ALTHOUGH THE SURVEYOR DOES CERTIFY THAT THEY ARE LOCATED AS ACCURATELY AS POSSIBLE FROM INFORMATION AVAILABLE. THE SURVEYOR HAS NOT PHYSICALLY LOCATED THE UNDERGROUND UTILITIES.

COPYRIGHT © 2024 WASHTENAW ENGINEERING COMPANY, INC. ALL RIGHTS RESERVED. NO REPRODUCTION SHALL BE MADE WITHOUT WRITTEN CONSENT OF WASHTENAW ENGINEERING COMPANY, INC.

THE OWNER SHALL NOT USE OR AUTHORIZE ANY OTHER PERSON TO USE THE DRAWINGS, SPECIFICATIONS, ELECTRONIC DATA AND OTHER INSTRUMENTS OF SERVICE FOR ANY OTHER PROJECT OR FOR CONSTRUCTION OF THE PROJECT OR FOR ANY OTHER PROJECT WITHOUT THE WRITTEN CONSENT OF WASHTENAW ENGINEERING COMPANY, INC. THE OWNER SHALL MAINTAIN AND HOLD HARMLESS THE ENGINEER, ARCHITECT, LANDSCAPE ARCHITECT AND EMPLOYEES OF ANY OF THEM FROM AND AGAINST ALL CLAIMS, DAMAGES, LOSSES AND EXPENSES, INCLUDING REASONABLE ATTORNEY'S FEES, ARISING OUT OF OR FROM THE USE OF THE DRAWINGS, SPECIFICATIONS, ELECTRONIC DATA OR OTHER INSTRUMENTS OF SERVICE.

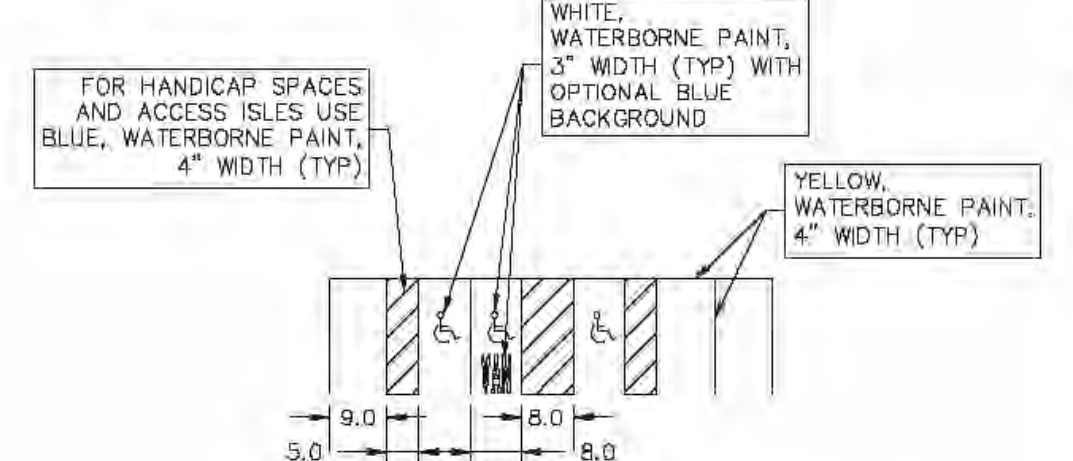
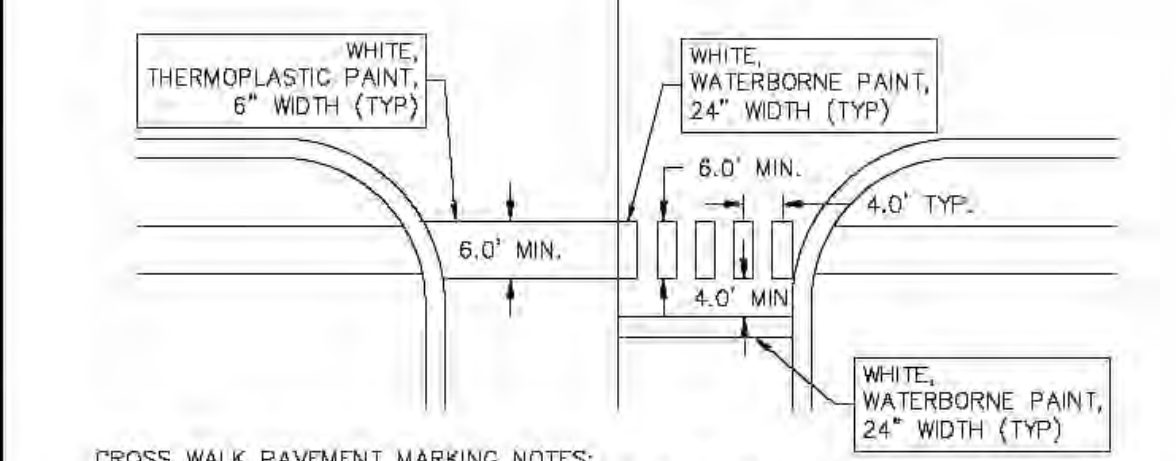
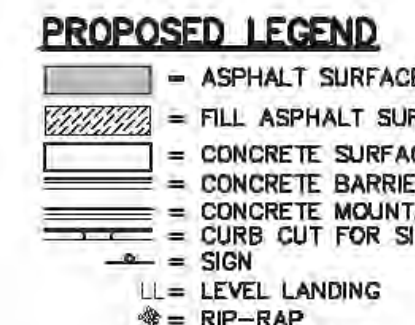
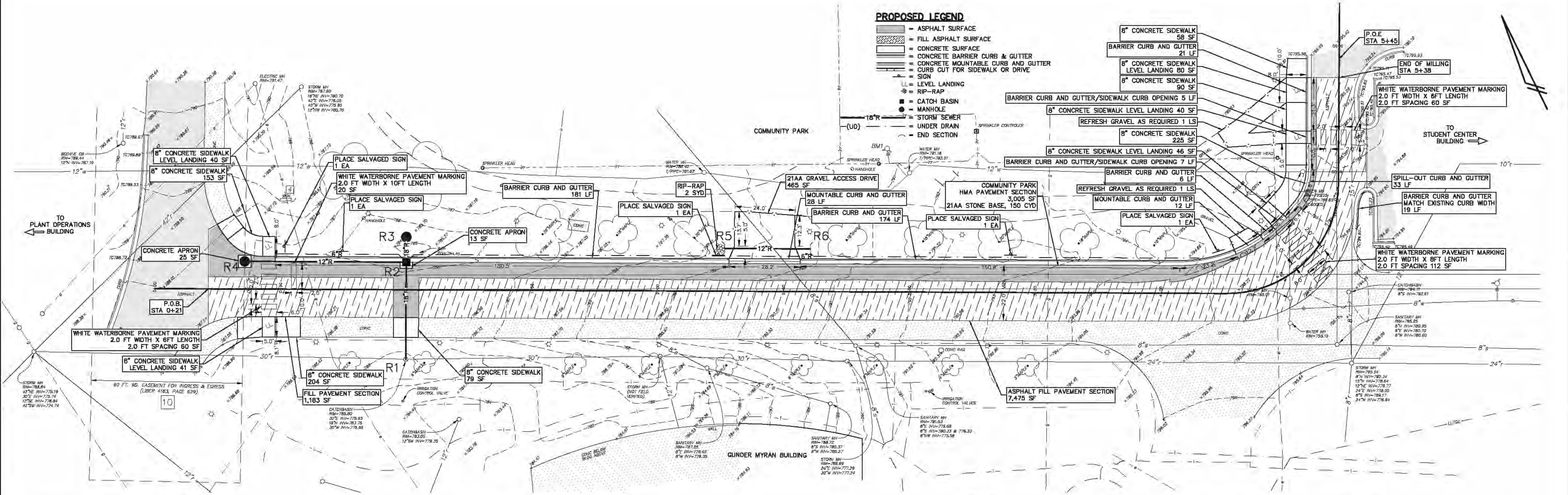

- SITE MATERIALS NOTES:**
1. ALL MATERIALS AND COMPACTION REQUIREMENTS SHALL MEET MDDT STANDARDS.
 2. ALL CONCRETE CURBING SHALL HAVE A MIN 4\"/>

COMPACTION NOTE:
USE OF NUCLEAR DENSITY GAUGE REQUIRES MEASURING THE PAVEMENT DENSITY USING THE THEORETICAL MAXIMUM SPECIFIC GRAVITY (Gmm) FROM THE JOB MIX FORMULA (JMF) FOR THE DENSITY CONTROL TARGET. THE REQUIRED IN-PLACE DENSITY OF THE HOT MIX ASPHALT (HMA) MIXTURE MUST BE 92.0 TO 98.0 PERCENT OF THE DENSITY CONTROL TARGET. NUCLEAR TESTING AND FREQUENCY WILL BE IN ACCORDANCE WITH THE MICHIGAN DEPARTMENT OF TRANSPORTATION (MDOT) DENSITY AND INSPECTION MANUAL.

PROOF ROLL NOTE:
COMPLETE A PROOF ROLL USING EQUIPMENT APPROVED BY THE ENGINEER. THE ENGINEER WILL WITNESS AND DOCUMENT THE PROOF ROLL AND DETERMINE THE PROPER COURSE OF ACTION TO CORRECT ANY OBSERVED RUTTING OR DISPLACEMENT.

- NOTES:**
1. ALL SIDEWALK TO COMPLY WITH CURRENT STATE AND FEDERAL AMERICANS WITH DISABILITIES (ADA) REQUIREMENTS.
 2. ALL PAVEMENT MARKINGS REMOVED OR DAMAGED FROM THIS PROJECT ARE TO BE REPLACED WITH WATERBORNE.
 3. A CONCRETE APRON IS PROPOSED FOR ALL CATCH BASINS THAT DO NOT CURRENTLY HAVE ONE.
 4. CONTRACTOR IS RESPONSIBLE FOR ACQUIRING ALL PERMITS REQUIRED FOR THIS PROJECT.
 5. REFRESH GRAVEL USING 2\"/>

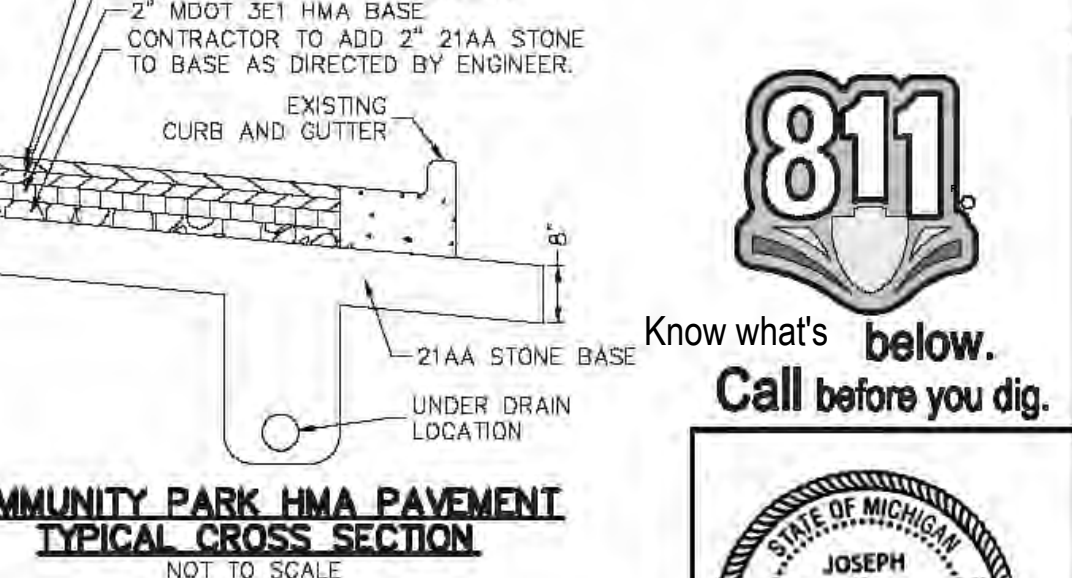
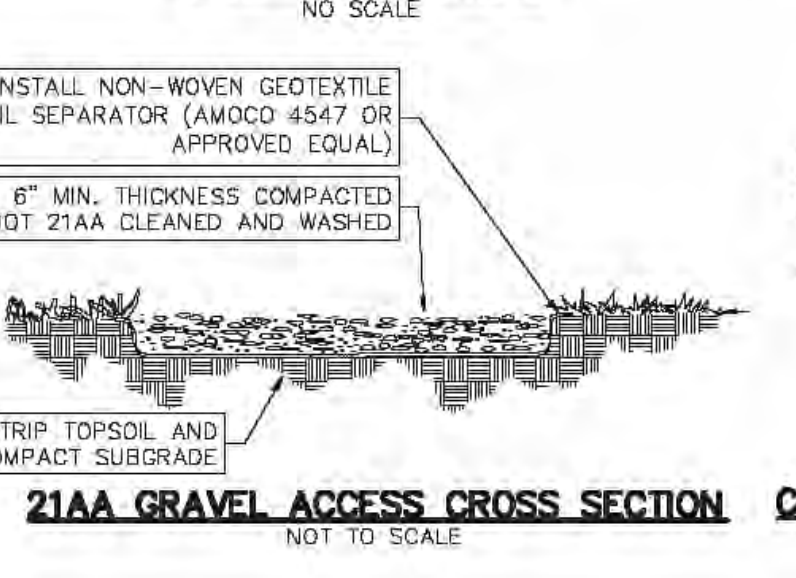
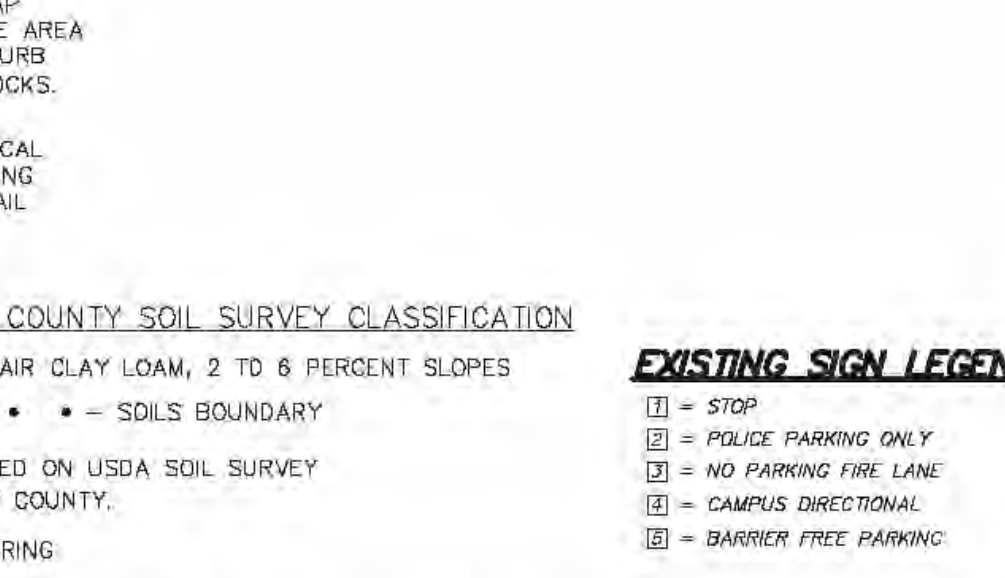
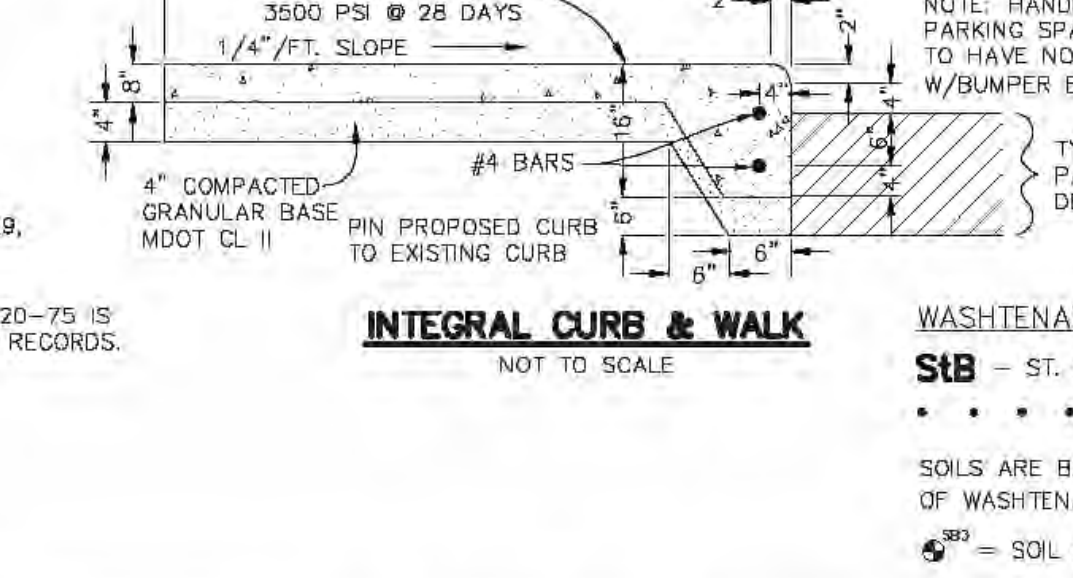
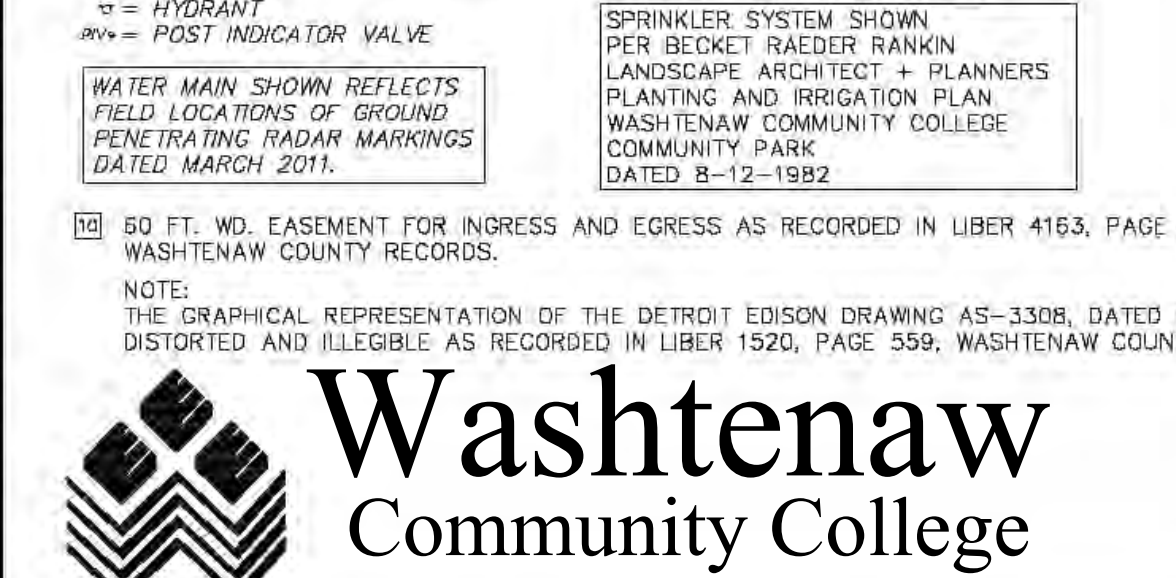
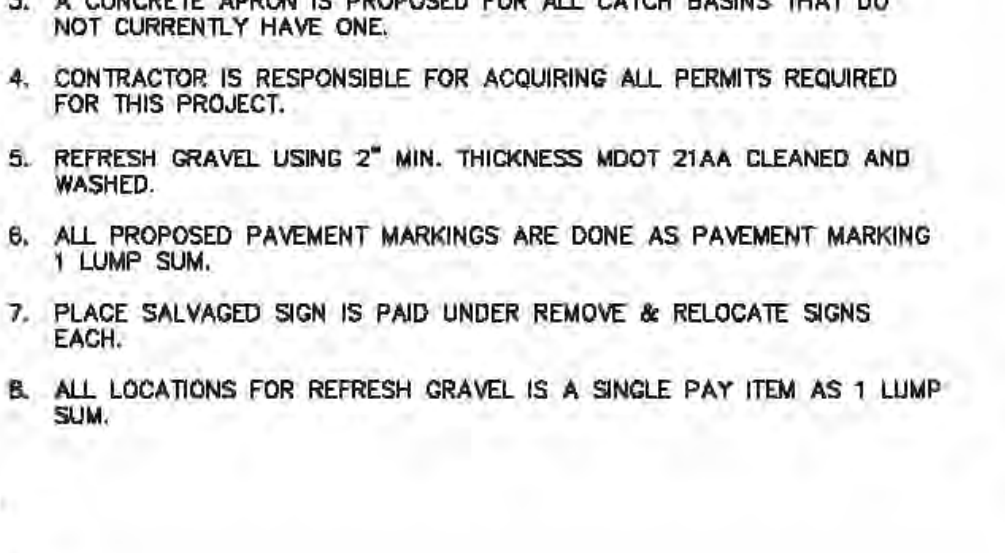
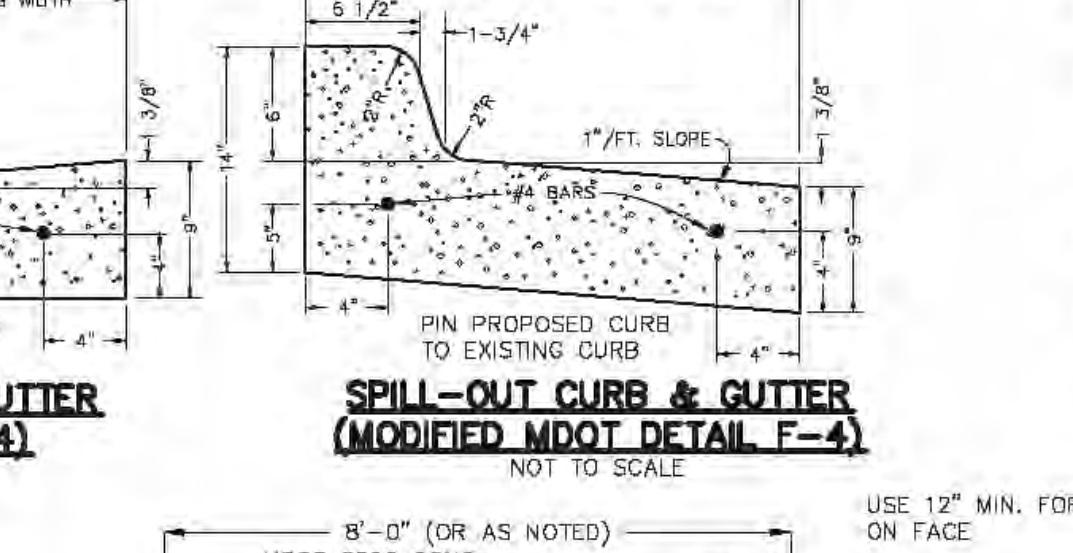
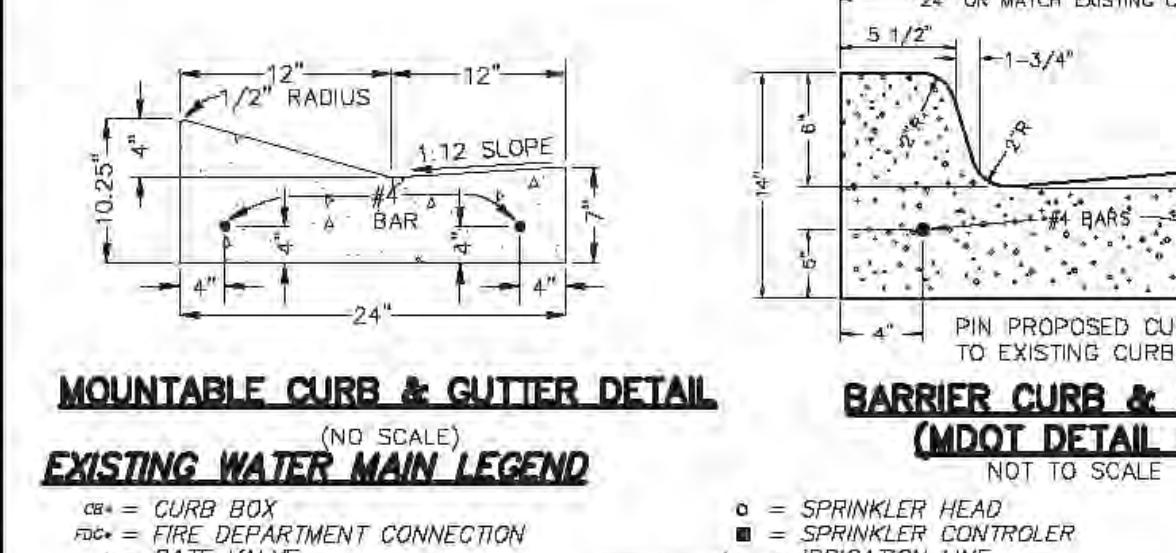
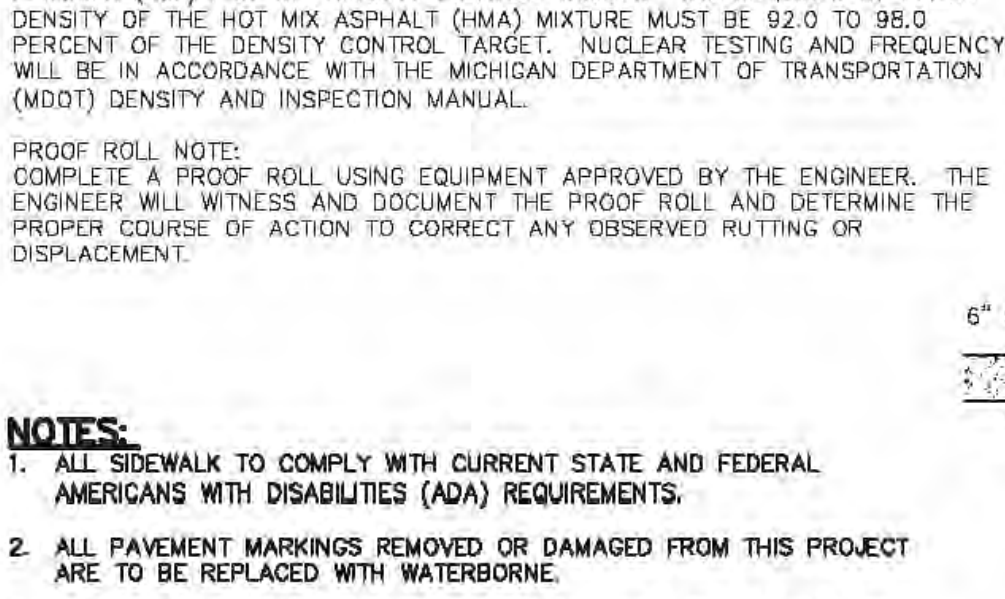
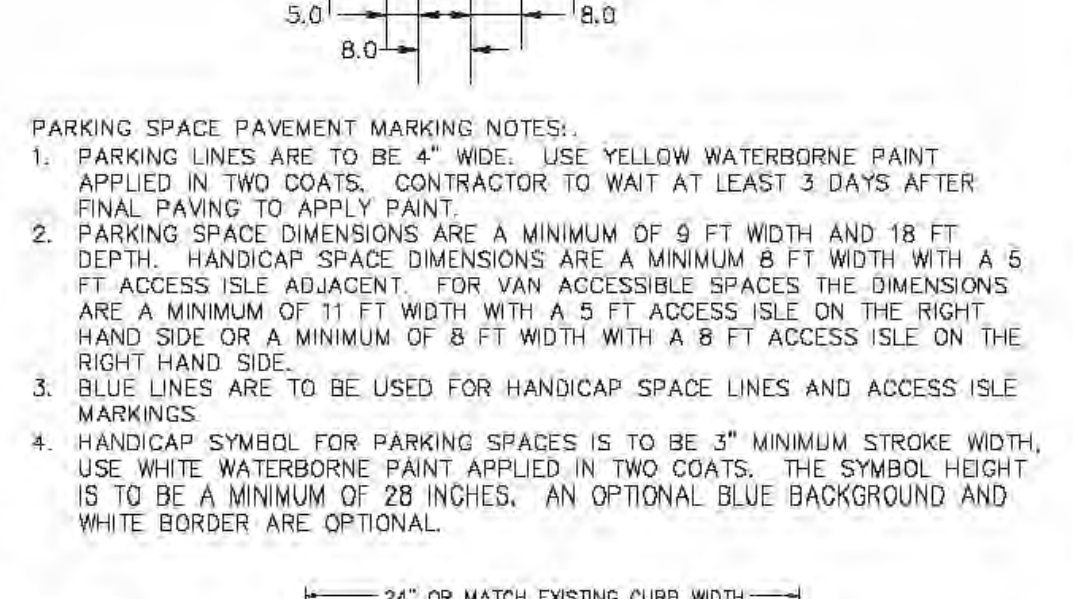
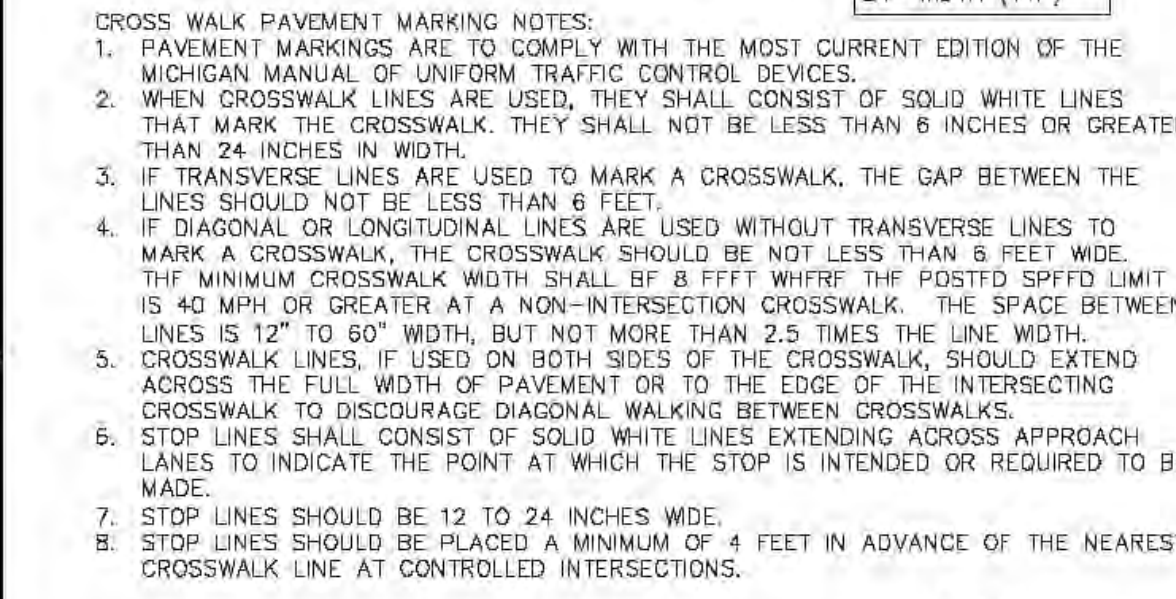
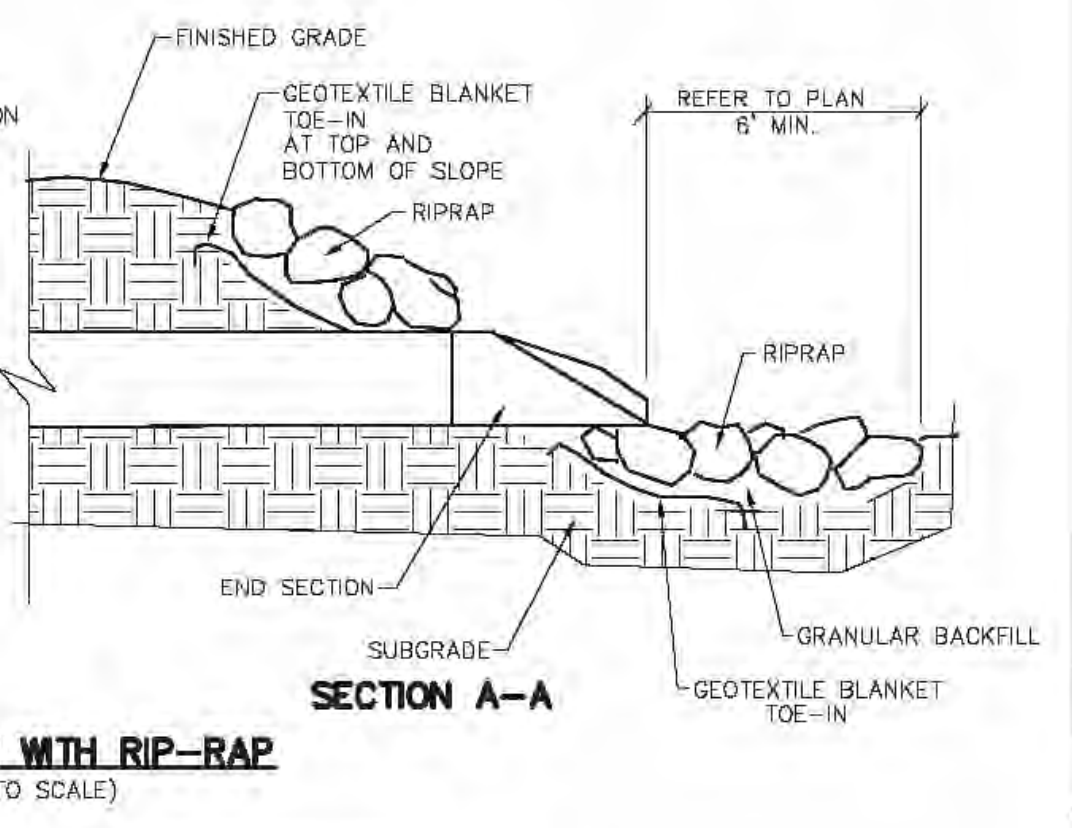
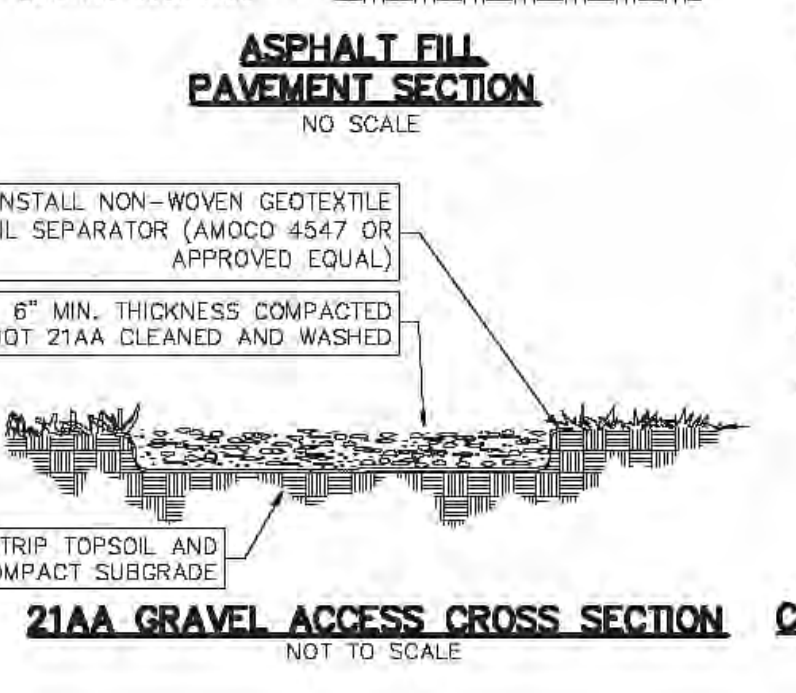
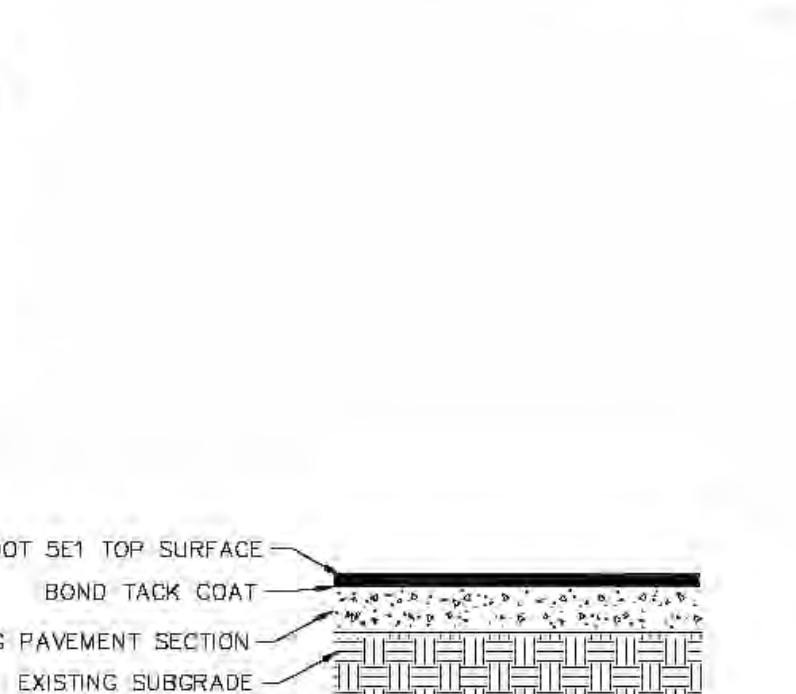
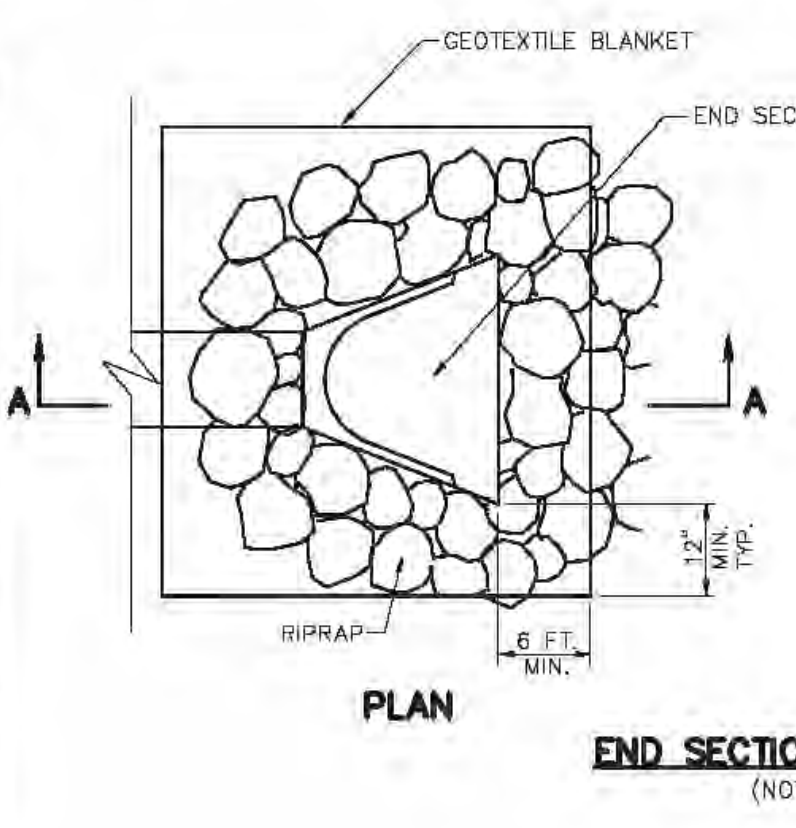
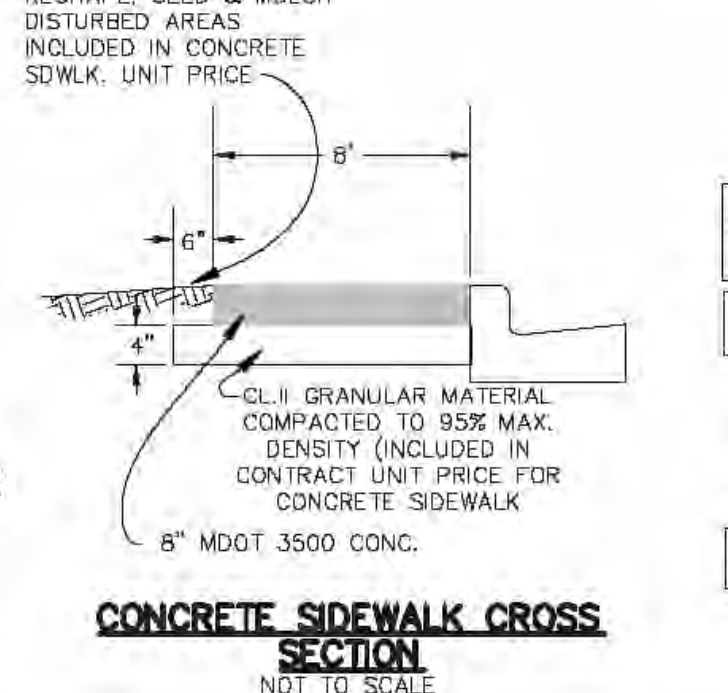
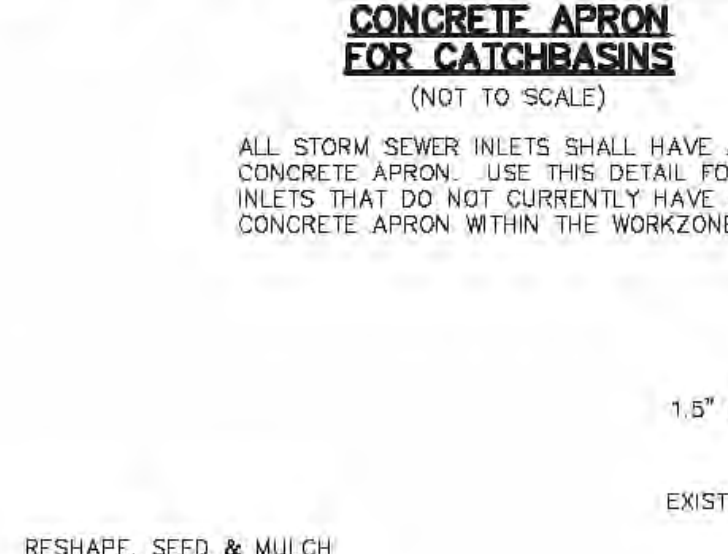
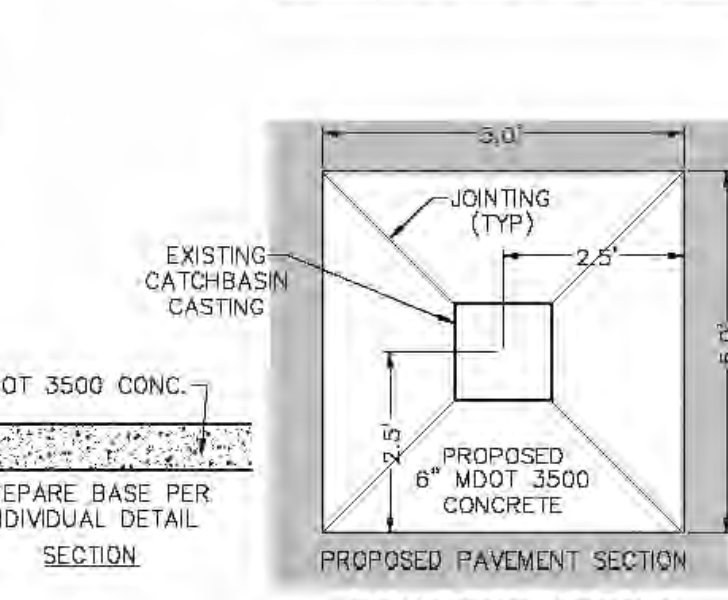
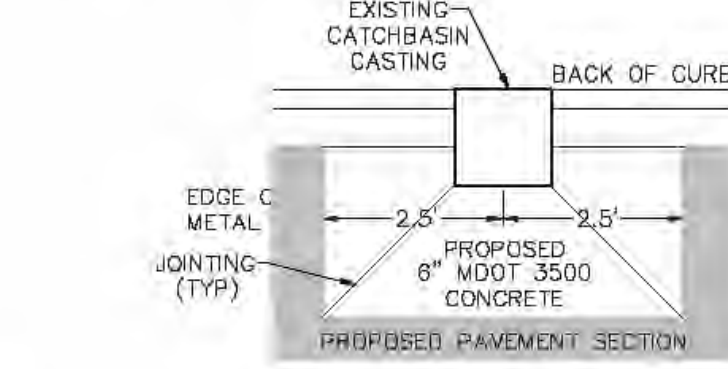

CIVIL ENGINEERS
PLANNERS • SURVEYORS
LANDSCAPE ARCHITECTS
3525 W. LIBERTY RD.
SUITE 400
ANN ARBOR, MI 48103
TEL: 734-761-8900

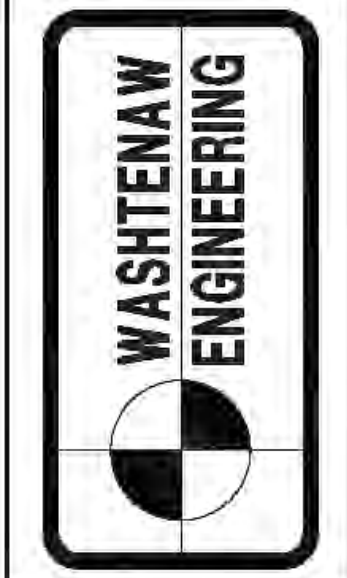

CLIENT
**WASHTENAW
COMMUNITY COLLEGE**
4800 E. HURON RIVER DR.
ANN ARBOR, MI 48106
TEL: 734-973-3300
www.wccnet.edu

SHEET
SITE PLAN

PROJECT
**CAMPUS WIDE
MAIN LOOP REPAIR
PROJECT #75295
PART 1**

SECTION 36 TOWN 2 SOUTH RANGE 6 EAST
ANN ARBOR TOWNSHIP
WASHTENAW COUNTY • MICHIGAN
JOB NO. 332285
DATE 5-28-2026
DWG NO. 285-g-site
FIELD BOOK NONE
FILE NO. 11013
811
Know what's below.
Call before you dig.
JOSEPH K. MAYNARD ENGINEER
No. 52559
5 SHEET

THE UNDERGROUND UTILITIES SHOWN HAVE BEEN LOCATED FROM FIELD SURVEY INFORMATION AND EXISTING RECORDS. THE SURVEYOR MAKES NO GUARANTEE THAT THE UNDERGROUND UTILITIES SHOWN COMPRISE ALL SUCH UTILITIES IN THE AREA, EITHER IN SERVICE OR ABANDONED. THE SURVEYOR DOES CERTIFY THAT THEY ARE LOCATED AS ACCURATELY AS POSSIBLE FROM INFORMATION AVAILABLE. THE SURVEYOR HAS NOT PHYSICALLY LOCATED THE UNDERGROUND UTILITIES.

COPYRIGHT © 2008 WASHTENAW ENGINEERING COMPANY, INC. NO PART OF THIS DRAWING IS TO BE REPRODUCED OR TRANSMITTED IN ANY FORM OR BY ANY MEANS WITHOUT THE WRITTEN CONSENT OF WASHTENAW ENGINEERING COMPANY, INC.

THE OWNER SHALL NOT USE OR AUTHORIZE ANY OTHER PERSON TO USE THE DRAWINGS, SPECIFICATIONS, ELECTRONIC DATA, AND OTHER INSTRUMENTS OF SERVICE ON OTHER PROJECTS. FOR ADDITIONS TO THIS PROJECT OR FOR COMPLETION OF THE PROJECT BY OTHER INSTRUMENTS OF SERVICE ON OTHER PROJECTS, THE SURVEYOR'S SERVICES SHALL BE IN DEFAULT UNDER THIS AGREEMENT. THE SURVEYOR SHALL NOT BE RESPONSIBLE FOR ANY DAMAGE TO OR DESTRUCTION OF ANY PROPERTY OR PERSONS OR ANY OTHER INSTRUMENTS OF SERVICE, INCLUDING BUT NOT LIMITED TO ATTORNEYS' FEES, ARISING OUT OF UNAUTHORIZED REUSE OF DRAWINGS, SPECIFICATIONS, ELECTRONIC DATA OR OTHER INSTRUMENTS OF SERVICE.

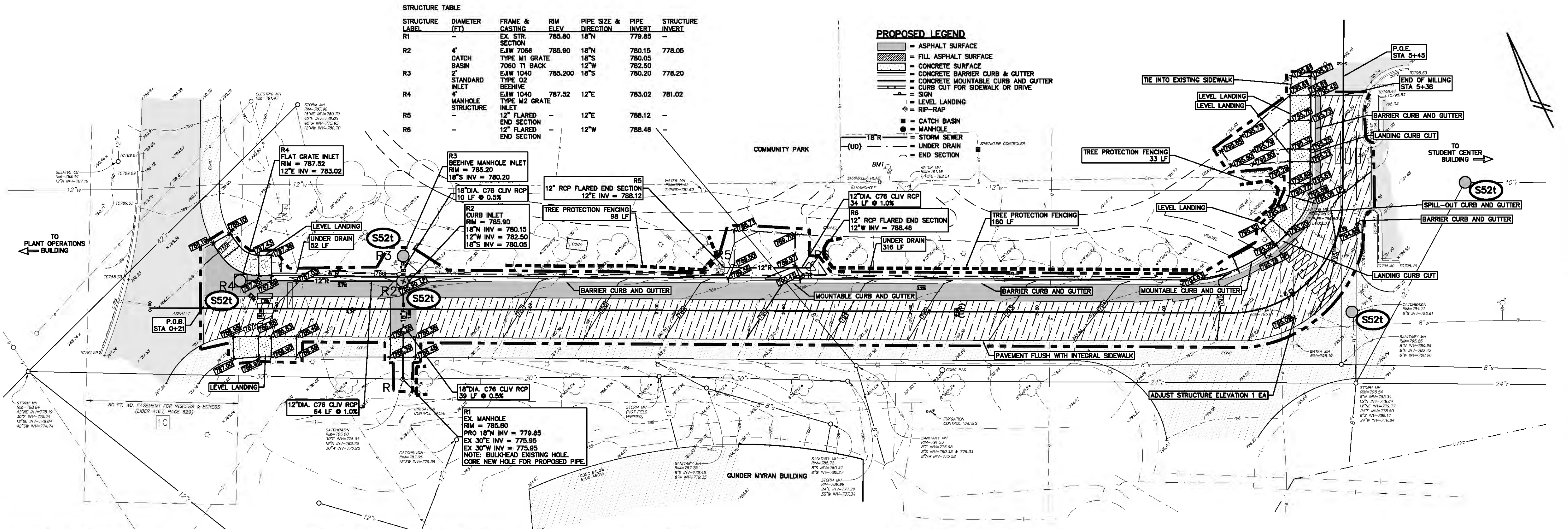

| Tasks | Collection System | | | Storm Water Management Basin | | | Scheduled Frequency |
|---|--------------------|-------------|--------------------|------------------------------|------------------|----------------------|---------------------------------|
| | Storm Sewer System | Catch Basin | Catch Basin Inlets | Sediment Basin | Outlet Structure | Storm Detention Area | |
| Inspect for Sediment Accumulation | X | X | X | X | X | X | Weekly |
| Remove Sediment Accumulation | X | X | X | X | X | X | As Needed & prior to Acceptance |
| Inspect for floatables and debris | X | X | X | X | X | X | Weekly |
| Remove floatables and debris | X | X | X | X | X | X | As Needed & prior to Acceptance |
| Inspect during wet weather & after major storms | X | X | X | X | X | X | As Needed |
| Repair Storm Damage to System and Erosion Control | X | X | X | X | X | X | As Needed |

| Tasks | Collection System | | | Storm Water Management Basin | | | Scheduled Frequency |
|--|--------------------|-------------|--------------------|------------------------------|------------------|----------------------|--------------------------------|
| | Storm Sewer System | Catch Basin | Catch Basin Inlets | Sediment Basin | Outlet Structure | Storm Detention Area | |
| Inspect for Sediment Accumulation | X | X | X | X | X | X | Annually |
| Remove Sediment Accumulation | X | X | X | X | X | X | As Needed |
| Inspect for floatables and debris | X | X | X | X | X | X | Annually |
| Remove floatables and debris | X | X | X | X | X | X | As Needed |
| Inspect during wet weather & after major storms | X | X | X | X | X | X | Minimum Annually and As Needed |
| Repair Storm Damage to System and Permanent Erosion Control | X | X | X | X | X | X | As Needed |
| Keep records on site of all maintenance inspections, actions and costs | | | | | | | Annually |

| Item No. | Description | Annual Cost |
|-----------------------------------|--|-------------|
| 1 | Annual Inspection for sediment accumulation | \$90.00 |
| 2 | Removal of sediment accumulation every 2 years as needed | \$1,200.00 |
| 3 | Inspect for floatables & debris annually and after major storms | \$180.00 |
| 4 | Removal of floatables and debris annually and after major storms | \$180.00 |
| 5 | Wet Weather Inspections and Report by Professional Engineer | \$360.00 |
| 6 | Records Maintenance | \$90.00 |
| Estimated Annual Maintenance Cost | | \$2,100.00 |

| ITEM DESCRIPTION | ESTIMATED QUANTITIES | UNIT | UNIT PRICE | AMOUNT |
|----------------------------------|----------------------|------|------------|----------|
| INLET FILTERS | 4 | EA | \$130.00 | \$520.00 |
| Dust Emission Control (Sweeping) | 1 | | | |

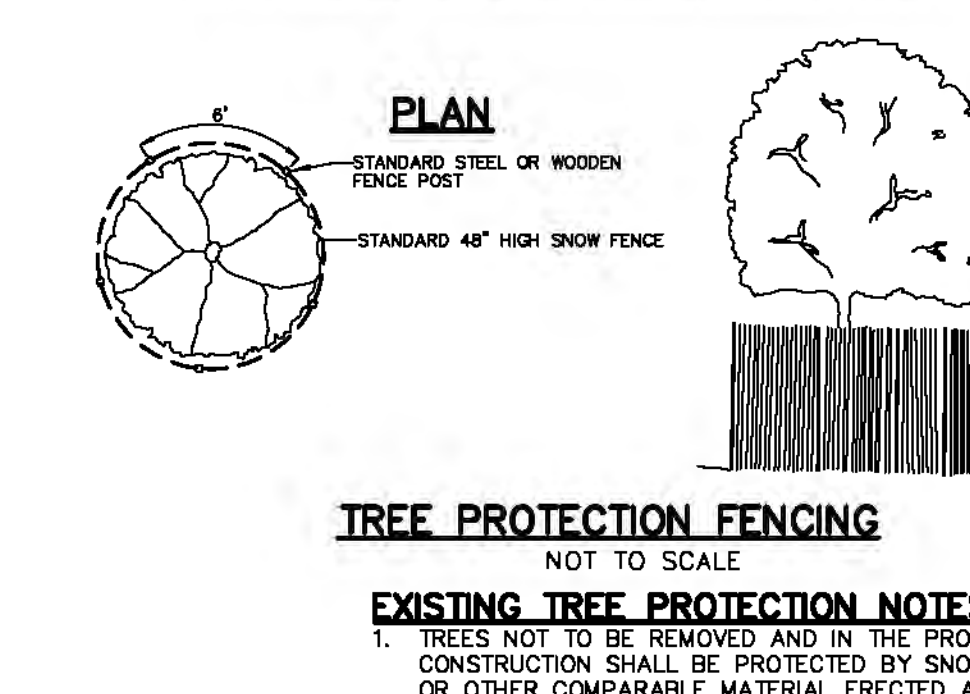
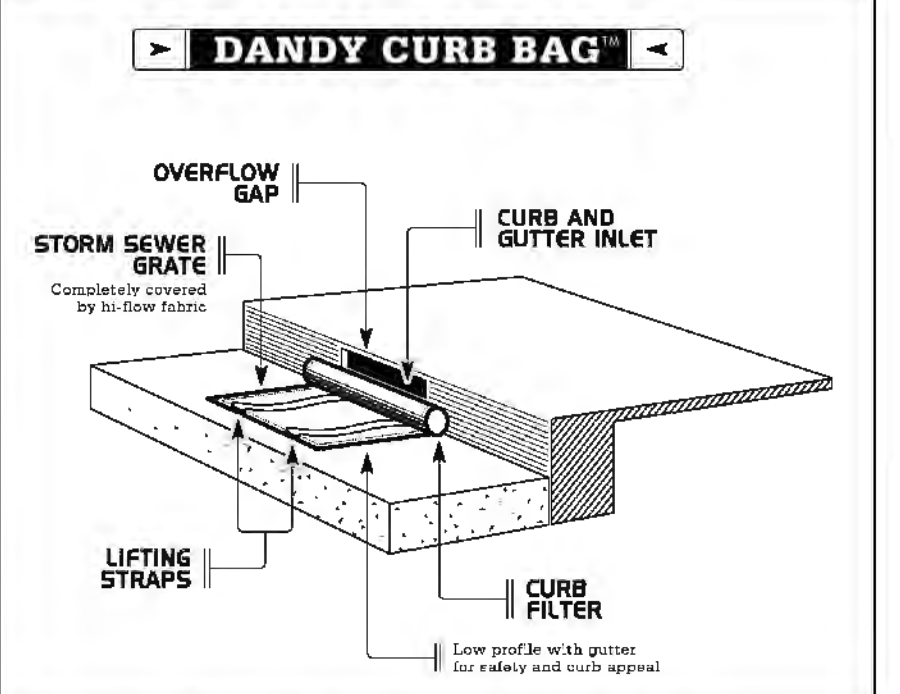

DANDY CURB BAG (SS2t)
NO SCALE

EXISTING WATER MAIN LEGEND

- SPRINKLER HEAD
- SPRINKLER CONTROLLER
- IRRIGATION LINE
- SPRINKLER SYSTEM SHOWN PER BECKETT RAEDER RANKIN LANDSCAPE ARCHITECT + PLANNERS PLANTING AND IRRIGATION PLAN WASHTENAW COMMUNITY COLLEGE COMMUNITY PARK DATED 8-12-1982

60 FT. WD. EASEMENT FOR INGRESS AND EGRESS AS RECORDED IN LIBER 4163, PAGE 629, WASHTENAW COUNTY RECORDS.

NOTE: THE GRAPHICAL REPRESENTATION OF THE DETROIT EDISON DRAWING AS-3308, DATED 1-20-75 IS DISTORTED AND ILLEGIBLE AS RECORDED IN LIBER 1520, PAGE 559, WASHTENAW COUNTY RECORDS.

LEGEND

- LIGHT POLE
- UTILITY POLE
- GUY ANCHOR
- HYDRANT
- SPOT ELEV.
- POST
- GATE VALVE
- SIGN
- TOP OF CURB
- TOP OF WALL
- MANHOLE
- CATCH BASIN
- END SECTION
- GRAVEL
- FENCE
- CONCRETE
- ASPHALT
- EXISTING STORM DRAIN
- EXISTING SANITARY
- EXISTING WATER
- EXISTING GAS
- EXISTING ELECTRIC
- EXISTING TELEPHONE

BENCHMARK BM1-TOP NUT ON HYDRANT, 116'± FROM THE NORTHEASTERLY CORNER OF GUNDER MYRAN BUILDING, ELEV=793.03 (NAVD. 88).

NOTES:

- ALL SIDEWALK TO COMPLY WITH CURRENT STATE AND FEDERAL AMERICANS WITH DISABILITIES (ADA) REQUIREMENTS.
- ALL PAVEMENT MARKINGS REMOVED OR DAMAGED FROM THIS PROJECT ARE TO BE REPLACED WITH WATERBORNE.
- A CONCRETE APRON IS PROPOSED FOR ALL CATCH BASINS THAT DO NOT CURRENTLY HAVE ONE.
- CONTRACTOR IS RESPONSIBLE FOR ACQUIRING ALL PERMITS REQUIRED FOR THIS PROJECT.
- SEDIMENT PROTECTION REQUIRED AT INLETS AS INDICATED.
- LIMITS OF DISTURBANCE AREA IS 0.41± ACRES (17,707 SF).

MICHIGAN DEPARTMENT OF MANAGEMENT AND BUDGET
S-E-S-C KEYING SYSTEM

PROGRAM OF CONTINUING MAINTENANCE
WASHTENAW COMMUNITY COLLEGE GROUNDS DEPARTMENT WILL BE RESPONSIBLE FOR SWEEPING OF THE PAVED AREAS AND RESTORATION OF THE ERODED AREAS.

WASHTENAW COUNTY SOIL SURVEY CLASSIFICATION
S1B - ST. CLAIR CLAY LOAM, 2 TO 6 PERCENT SLOPES

EXISTING SIGN LEGEND

- STOP
- POLICE PARKING ONLY
- NO PARKING FIRE LANE
- CAMPUS DIRECTIONAL
- BARRIER FIRE PARKING

GENERAL

- THE ANN ARBOR CHARTER TOWNSHIP ORDINANCE IS MORE RESTRICTIVE THAN PART 91 AND THE RULES AS IT GOVERNS ALL EARTH CHANGES REGARDLESS OF SIZE, UNLESS OTHERWISE EXEMPTED.
- THE CONTRACTOR SHALL IMPLEMENT AND MAINTAIN THE SOIL EROSION CONTROL MEASURES AS SHOWN ON THE PLANS AT ALL TIMES DURING CONSTRUCTION ON THIS PROJECT. ANY MODIFICATIONS OR ADDITIONS TO THE SOIL EROSION CONTROL MEASURES DUE TO CONSTRUCTION OR CHANGED CONDITIONS, SHALL BE COMPLIED WITH AS REQUIRED OR DIRECTED BY THE OWNER, PROJECT ENGINEER OR ANN ARBOR TOWNSHIP.
- ALL SOIL EROSION AND SEDIMENTATION CONTROL WORK SHALL CONFORM TO THE PERMIT REQUIREMENTS OF ANN ARBOR TOWNSHIP AND THE LAWS OF THE STATE OF MICHIGAN.
- AN NPDES CONSTRUCTION ACTIVITY PERMIT IS REQUIRED FOR ALL SITES GREATER THAN 5 ACRES.
- DAILY INSPECTIONS SHALL BE MADE BY THE CONTRACTOR. PERIODIC INSPECTIONS MAY BE MADE BY THE OWNER/PROJECT ENGINEER/TOWNSHIP TO DETERMINE THE EFFECTIVENESS OF EROSION AND SEDIMENTATION CONTROL MEASURES. ANY NECESSARY CORRECTIONS SHALL BE MADE WITHOUT DELAY.
- EROSION AND SEDIMENTATION FROM WORK ON THE SITE SHALL BE CONTAINED ON THE SITE AND NOT BE ALLOWED TO COLLECT ON ANY OFF-SITE AREAS OR IN WATERWAYS.
- ALL MUD/DIRT TRACKED ONTO ROADS FROM THE SITE DUE TO CONSTRUCTION, SHALL BE PROMPTLY REMOVED BY THE CONTRACTOR.
- RESTORATION OF ALL DISTURBED AREAS, INCLUDING PLACEMENT OF TOPSOIL, SEED, FERTILIZER AND MULCH AND/OR SOD SHALL BE DONE WITHIN 5 DAYS OF THE COMPLETION OF FINAL GRADE.
- CONSTRUCTION OPERATIONS SHALL BE SCHEDULED AND PERFORMED SO THAT PREVENTATIVE SOIL EROSION CONTROL MEASURES ARE IN PLACE PRIOR TO EXCAVATION IN CRITICAL AREAS AND TEMPORARY STABILIZATION MEASURES ARE IN PLACE IMMEDIATELY FOLLOWING BACKFILLING OPERATIONS.
- SPECIAL PRECAUTIONS WILL BE TAKEN IN THE USE OF CONSTRUCTION EQUIPMENT TO PREVENT SITUATIONS THAT PROMOTE EROSION.
- PROPER DUST CONTROL SHALL BE MAINTAINED DURING CONSTRUCTION BY USE OF WATER TRUCKS AND/OR CHLORIDE AS REQUIRED.
- THE CONTRACTOR SHALL BE RESPONSIBLE FOR MAINTAINING ALL TEMPORARY SOIL EROSION CONTROL MEASURES AND REMOVAL OF SOME UPON AUTHORIZED COMPLETION OF PROJECT. COMPLETION OF PROJECT WILL NOT BE AUTHORIZED UNTIL ALL SITE WORK, HOME BUILDING, ROAD WORK AND UTILITY CONSTRUCTION IS COMPLETE AND ALL SOILS ARE STABILIZED.
- THE CONTRACTOR SHALL NOT GRADE IN EXISTING WETLAND OR CONSERVATION AREAS TO BE PROTECTED. SILT FENCE SHALL BE INSTALLED AND MAINTAINED ADJACENT TO EXISTING WETLAND AND CONSERVATION AREAS TO PREVENT GRADING, EROSION AND SEDIMENTATION INTO THEM.
- TREE PROTECTION FENCING MUST REMAIN INTACT UNTIL RESTORATION OF THE SITE IS COMPLETE.

NOTE: A FIELD PRE-CONSTRUCTION MEETING MUST BE HELD PRIOR TO ANY EARTH-CHANGE ACTIVITY.

NOTE: ANY SOIL STOCKPILE AREAS SHALL HAVE SILT FENCE INSTALLED AND MAINTAINED AROUND THE PERIMETER.

SEQUENCE OF CONSTRUCTION

- INSTALL TREE PROTECTION FENCING PRIOR TO ANY GRADING OPERATION.
- INSTALL INLET FILTERS IN EXISTING CATCH BASINS.
- ROUGH GRADE SITE, STOCKPILE TOPSOIL AND BEGIN BUILDING CONSTRUCTION.
- MILL EXISTING PAVEMENT.
- INSTALL STORM DRAINAGE SYSTEM AND ADDITIONAL INLET FILTERS.
- MAINTAIN EROSION AND SEDIMENTATION CONTROL MEASURES, AS REQUIRED.
- BRING PAVEMENT AREAS TO SUB-BASE GRADE, PLACE SUB-BASE AND BITUMINOUS PAVEMENT.
- FINISH GRADE, REDISTRIBUTE TOPSOIL, SEED AND MULCH ALL DISTURBED AREAS.
- REMOVE ANY ACCUMULATED SEDIMENT WITHIN THE STORM SYSTEM IMPACTED BY THIS PROJECT.
- COMPLETE CONSTRUCTION OF SITE.
- INSURE ALL SOIL IS STABILIZED. REMOVE ALL TEMPORARY SOIL EROSION CONTROL MEASURES.

SEEDING/SOD

- SEED OR SOD IN ACCORDANCE WITH PROJECT SPECIFICATIONS.
- ALL AREAS OF DISTURBED EARTH THAT ARE NOT TO BE PAVED OR SODDED SHALL HAVE 4 INCHES OF TOPSOIL, SEED, FERTILIZER AND MULCH.
- IMMEDIATELY AFTER SEEDING, MULCH ALL SEEDED AREAS WITH UNWEATHERED SMALL GRAIN STRAW (PREFERABLY WHEAT) OR HAY SPREAD. SPREAD UNIFORMLY AT THE RATE OF 1 TO 2 TONS OR 100 POUNDS (2 TO 3 BALES) PER 1,000 SQUARE FOOT. THIS MULCH SHOULD BE ANCHORED WITH A DISC-TYPE MULCH ANCHORING TOOL.
- ANY DISTURBED AREA NOT PAVED, SEEDING OR MULCHED, SODDED OR BUILT UPON BY NOVEMBER 15, IS TO BE MULCHED IN THE MANNER AS SPECIFIED ABOVE, IN ORDER TO PROVIDE SOIL EROSION PROTECTION DURING THE WINTER AND EARLY SPRING.
- ALL EROSION AND SEDIMENTATION CONTROL PREVENTION PROCEDURES AND STRUCTURES ARE TO COMPLY WITH THE STANDARDS AND SPECIFICATIONS FOR SOIL EROSION AND SEDIMENT CONTROL OF THE WASHTENAW COUNTY SOIL CONSERVATION DISTRICT.

CATCH BASIN/MANHOLE PROTECTION

- PROTECT STORM SEWER CATCH BASINS WITH DANDY PRODUCTS INC. OR APPROVED EQUIVALENT AS FOLLOWS:
 - DANDY BAG FOR 1040 STORM COVERS
 - BEHAVIOR DAM FOR ALL CURB STRUCTURES
 - DANDY SOCK FOR ALL DETENTION POND OUTLET STRUCTURES.

ROADS

- DURING CONSTRUCTION, ALL ROADS SHALL BE PROTECTED FROM UNVEGETATED AREAS WASHING ONTO ROAD SURFACES BY PLACEMENT OF SILT FENCE BEHIND CURB OR A 10 FOOT WIDE STRAW MULCH BANK BEHIND CURB OR OTHER APPROVED METHOD AND/OR AS SHOWN ON THE PLANS.
- DURING CONSTRUCTION OF ANY PORTION OF THE PROJECT, ROADS SHALL BE MAINTAINED FREE OF DIRT, SILT AND CONSTRUCTION DEBRIS.

SCALE
0 10 20 40
SCALE: 1"=20'

PREPARED BY: *Joseph K. Maynard*
JOSPH K. MAYNARD P.E., MICH No. 52559

811
Know what's below.
Call before you dig.

JOSEPH MAYNARD ENGINEER
No. 52559
PROFESSIONAL

WASHTENAW ENGINEERING
CIVIL ENGINEERS
PLANNERS • SURVEYORS
LANDSCAPE ARCHITECTS
3526 W. LIBERTY RD
SUITE 400
ANN ARBOR, MI 48105
TEL: 734-761-8800
WWW.WCENET.COM

CLIENT
WASHTENAW COMMUNITY COLLEGE
4900 E. HURON RIVER DR
ANN ARBOR, MI 48105
TEL: 734-973-3300
WWW.WCENET.COM

SHEET
GRADING, UTILITY AND SOIL EROSION CONTROL PLAN

PROJECT
CAMPUS WIDE MAIN LOOP REPAIR PROJECT #75295 PART 1

SECTION 36 **TOWN** 2 **SOUTH** 6 **RANGE** 6 **EAST**

DATE 5-28-2026 **JOB NO.** 3.3285 **DWG. NO.** 285-g-97d **FIELD BOOK** NONE **FILE NO.** 11013

6 SHEET

THE OWNER SHALL NOT USE OR AUTHORIZE ANY OTHER PERSON TO USE THE DRAWINGS, SPECIFICATIONS, ELECTRONIC DATA AND OTHER INSTRUMENTS OF SERVICE ON OTHER PROJECTS, FOR ADDITIONS TO THIS PROJECT OR FOR COMPLETION OF THE PROJECT BY OTHERS SO LONG AS WASHTENAW ENGINEERING COMPANY (WECO) IS NOT ADJUSTED TO BE IN DEFAULT UNDER THIS AGREEMENT. REUSE WITHOUT WECO'S PROFESSIONAL INVOLVEMENT WILL BE AT THE OWNER'S SOLE RISK AND WITHOUT LIABILITY TO WECO. THE OWNER SHALL INDEMNIFY AND HOLD HARMLESS WECO, WECO'S CONSULTANTS AND AGENTS AND EMPLOYEES OF ANY OF THEM FROM AND AGAINST CLAIMS, DAMAGES, LOSSES AND EXPENSES, INCLUDING BUT NOT LIMITED TO ATTORNEY'S FEES, ARISING OUT OF UNAUTHORIZED REUSE OF DRAWINGS, SPECIFICATIONS, ELECTRONIC DATA OR OTHER INSTRUMENTS OF SERVICE.

COPYRIGHT © 2026 WASHTENAW ENGINEERING COMPANY, INC.
NO REPRODUCTION SHALL BE MADE WITHOUT PRIOR WRITTEN CONSENT OF WASHTENAW ENGINEERING COMPANY, INC.

THE UNDERGROUND UTILITIES SHOWN HAVE BEEN LOCATED FROM FIELD SURVEY INFORMATION AND EXISTING RECORDS. THE SURVEYOR MAKES NO GUARANTEES THAT THE UNDERGROUND UTILITIES SHOWN COMPRISE ALL SUCH UTILITIES IN THE AREA, EITHER IN-SERVICE OR ABANDONED. THE SURVEYOR FURTHER DOES NOT WARRANT THAT THE UNDERGROUND UTILITIES SHOWN ARE IN THE EXACT LOCATION INDICATED. ALTHOUGH THE SURVEYOR DOES CERTIFY THAT THEY ARE LOCATED AS ACCURATELY AS POSSIBLE FROM INFORMATION AVAILABLE, THE SURVEYOR HAS NOT PHYSICALLY LOCATED THE UNDERGROUND UTILITIES.

Washtenaw
Community College

- LEGEND**
- = LIGHT POLE
 - = UTILITY POLE
 - = GUY ANCHOR
 - = SPOT ELEV.
 - = POST
 - = GATE VALVE
 - = SIGN
 - = TOP OF CURB
 - = TOP OF WALL
 - = MANHOLE
 - = CATCHBASIN
 - = END SECTION
 - = GRAVEL
 - = CONCRETE
 - = ASPHALT
 - = EXISTING STORM
 - = EXISTING WASTEWATER
 - = EXISTING GAS
 - = EXISTING ELECTRIC
 - = EXISTING TELEPHONE

BENCHMARK BM1-TOP NUT ON HYDRANT, 116.3' FROM THE NORTHEASTERLY CORNER OF GANDER MRYAN BUILDING, ELEV=783.00 (NAVD 88)

REVISIONS

| NO. | DATE | DESCRIPTION |
|-----|------|-------------|
| | | |
| | | |
| | | |

SCALE
NO SCALE

PREPARED BY: *Joseph K. Maynard*
 JOSEPH K. MAYNARD P.E., MICH. NO. 52559

Know what's below.
Call before you dig.

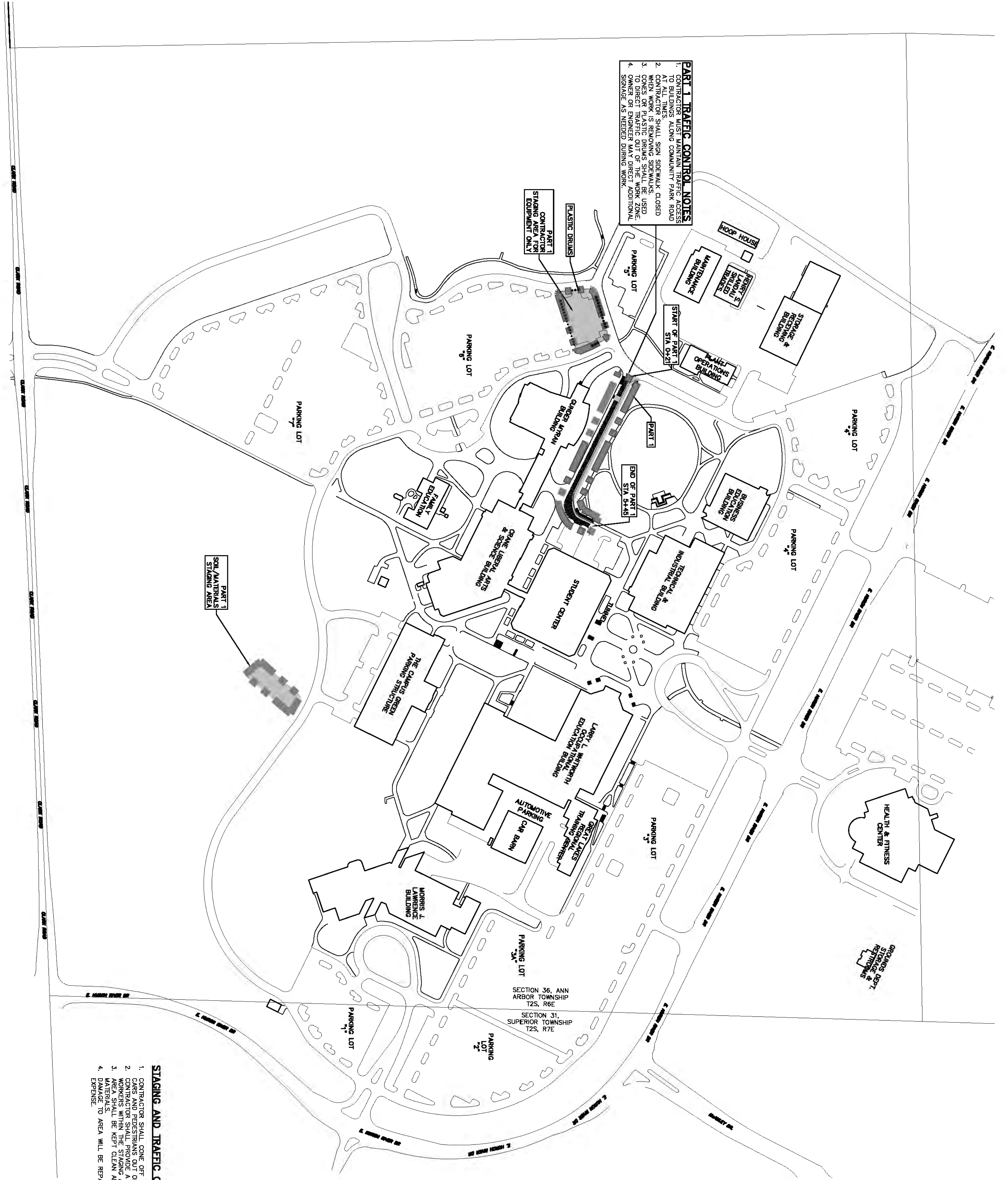
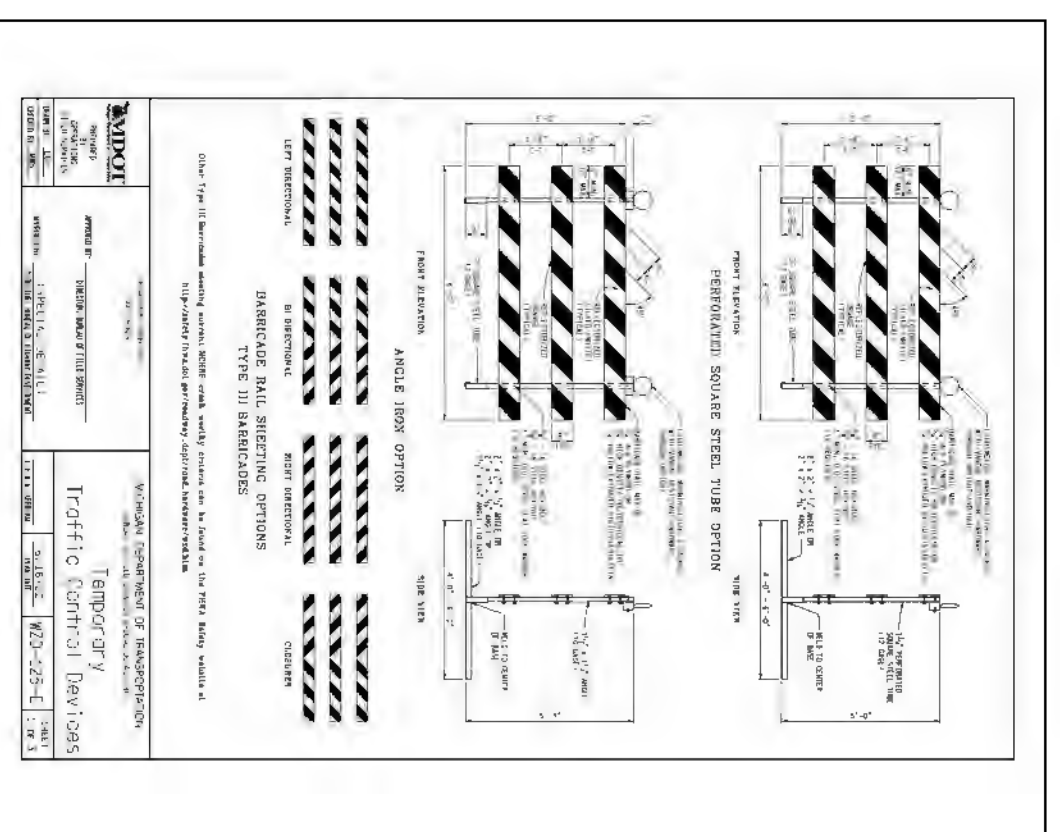
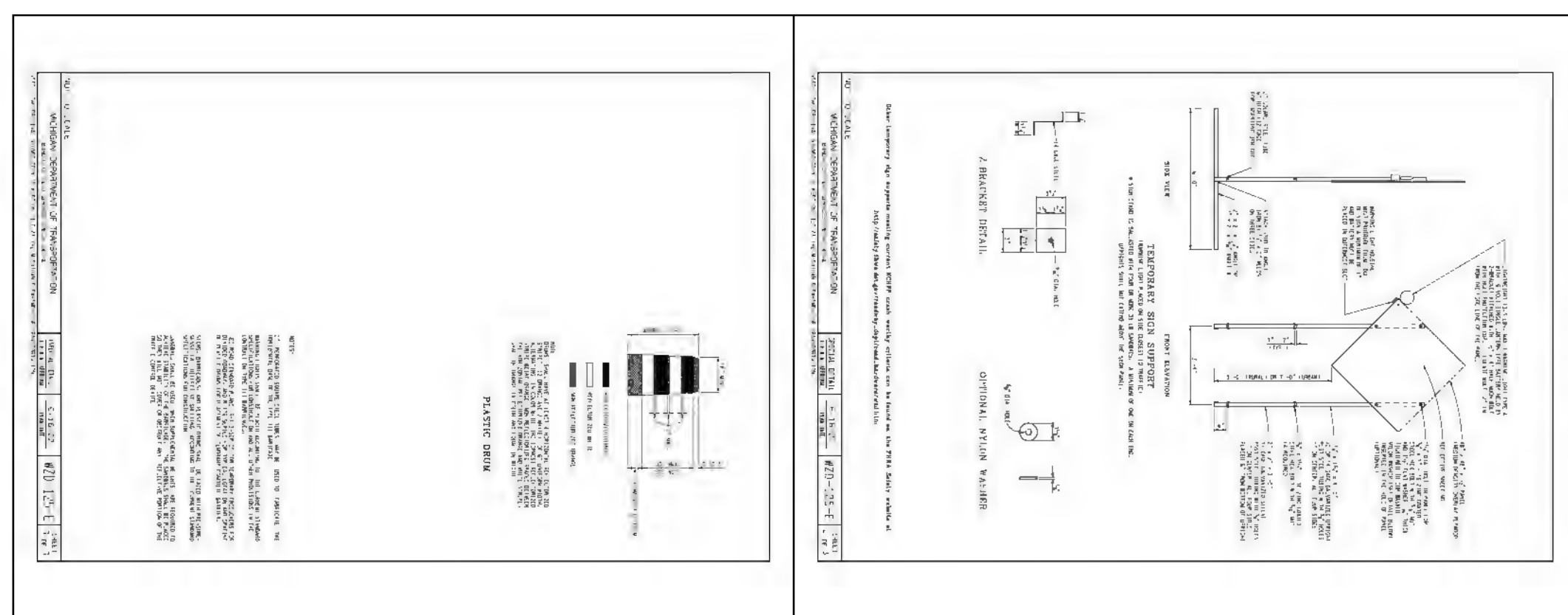

- STAGING AND TRAFFIC CONTROL NOTES**
- CONTRACTOR SHALL COME OFF STAGING AREA TO KEEP CARS AND PEDESTRIANS OUT OF THE AREA.
 - CONTRACTOR SHALL PROVIDE A PORTA-POTTY FOR THE AREA. AREA SHALL BE KEPT CLEAN AND NOT USED TO STORE MATERIALS. TO AREA WILL BE REPAIRED AT CONTRACTORS EXPENSE.

END ROAD WORK
G20-2
36 x 18"

WORK ZONE BEGINS
R5-18c
48x48

SIDEWALK CLOSED
R9-9
12 x 24"

NO PARKING
W20-7a
36 x 36

| | | | | |
|---|-----------------|---------------------|---------|------|
| SECTION 36 | TOWN 2 | SOUTH | RANGE 6 | EAST |
| ANN ARBOR TOWNSHIP WASHTENAW COUNTY • MICHIGAN | | | | |
| DATE 5-28-2026 | JOB NO. 33285 | DWG NO. 285-g-phase | | |
| SHEET 7 | FIELD BOOK NONE | FILE NO. 11013 | | |

PROJECT
CAMPUS WIDE MAIN LOOP REPAIR PROJECT #75295 PART 1

SHEET
PHASING AND STAGING PLAN

CLIENT
WASHTENAW COMMUNITY COLLEGE
 4800 E. HURON RIVER DR
 ANN ARBOR, MI 48105
 TEL 734-973-3300
 www.wccnet.edu

WASHTENAW ENGINEERING

CIVIL ENGINEERS
 PLANNERS • SURVEYORS
 LANDSCAPE ARCHITECTS
 3526 W. LIBERTY RD.
 SUITE 400
 ANN ARBOR, MI 48103
 TEL: 734-761-8800